

1 

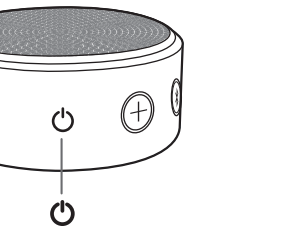

2 

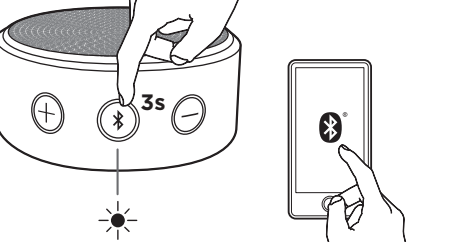

3.1 

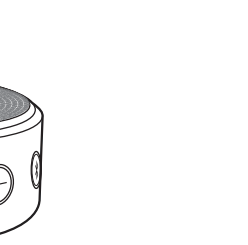
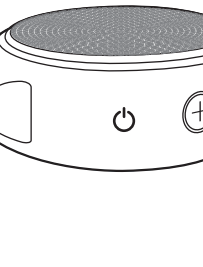
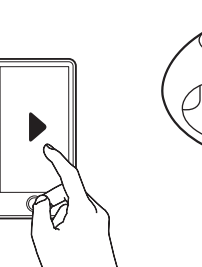

 Logitech 罗技

Logitech assumes no responsibility for any errors that may appear in this manual. Information contained herein is subject to change without notice.

1-year limited hardware warranty

© 2013 Logitech. Logitech, the Logitech logo, and other Logitech marks are owned by Logitech and may be registered. The Bluetooth word mark and logos are registered trademarks owned by Bluetooth SIG, Inc. and any use of such marks by Logitech is under license. All other trademarks are property of their respective owners.

Made in China.

罗技对于本手册中可能出现的任何错误不承担任何责任。本手册中包含的信息如有更改，恕不事先通知。

1 年有限硬件质保

版权所有 ©2013 年罗技。罗技、罗技标志、Logitech 和其他罗技商标均归罗技所有，并或已注册。Bluetooth 文字商标和标志是由 Bluetooth SIG, Inc. 所有的注册商标，罗技对此类商标和标志的所有使用均已获得授权。所有其它商标均是各自所有者的财产。
中国制造。

3.2 ▶

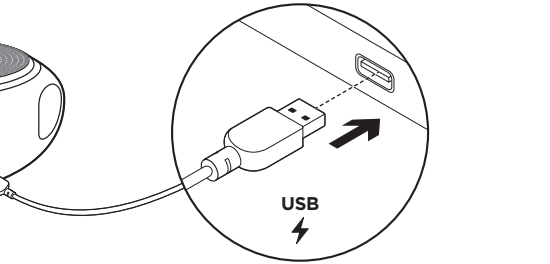
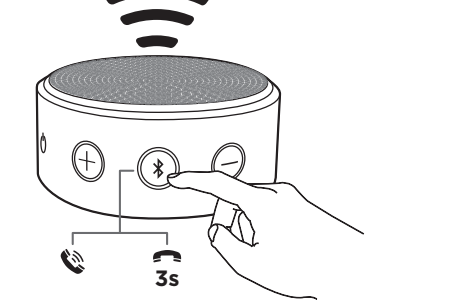
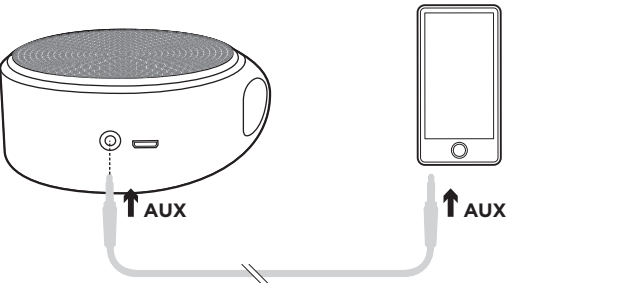

Logitech.com/x100/support

Logitech 罗技

X100

