



bemo

 Logitech®

Quick Start Guide

Welcome

Hi. Thanks for purchasing Bemo. Whether you are filming your first festival, taking a trip down the Camino de Santiago, or just want to share a first person perspective of your day, Bemo has you covered.

Contents Included:

1. Bemo social camera
2. 4GB microSD Card*
(Up to 3 hours of video)
3. Micro USB Cable
4. Lanyard
5. User documentation

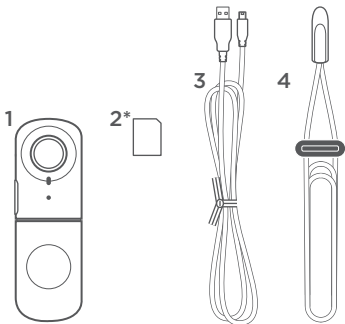

*Pre-installed in the Bemo social camera

Getting Started

To begin recording video move the slide switch to On.

Video Mode: Press and hold the capture button to take short video bursts.

The LEDs on the side will show the length of your active recording. You can edit and share these videos with the Bemo app.

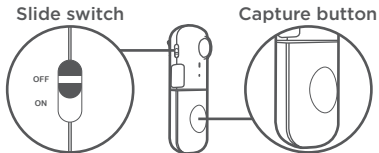

When you turn on your Bemo, the LEDs on the side will light up to show how much charge it has. If the battery is low, the bottom LED light will blink.

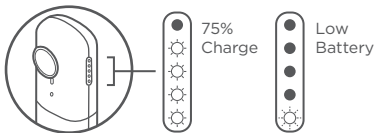

Download and Connect

Download the Bemo app from the Apple App Store.

Connect

When you launch the Bemo app for the first time, you will be guided through the process to pair your Bemo to your iPhone. Press the *Bluetooth* pairing button on your Bemo to make it discoverable. Upon successful pairing, the *Bluetooth* LED will rapidly flash, then turn off.

Note: *Bluetooth*® should be enabled on your iPhone before attempting to pair with your Bemo.

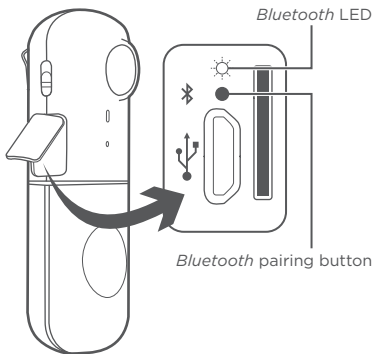

Using the Bemo app

The Bemo app will allow you to do the following:

- Discover the content you've captured with your camera
- Assemble your short video clips to create shareable moments
- Use the live viewfinder to make sure your activity is in frame
- Remotely trigger your camera via your iPhone
- Activate time lapse to create awesome stop motion video clips
- Keep an eye on your camera's status (battery, memory, etc.)

The Bemo app will also help you apply new firmware updates to your camera.



Charging and Storage

Plug the supplied micro USB cable into any charger or USB port of a laptop to charge your Bemo.

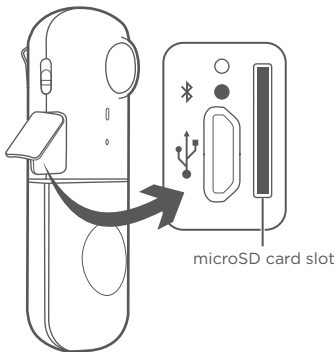

Your Bemo comes with a 4GB micro SD card preinstalled. The Micro USB port can be found on the side of the Bemo, below the *Bluetooth* pairing button.

Installing the Lanyard

Pull the lanyard up under the back clip to attach to your Bemo.

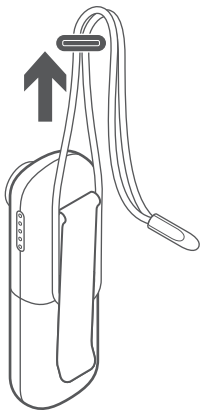

Please place the cord adjuster behind your neck to customize the lanyard length.

Technical Specs

Size (Circumference):

92mm x 30mm x 27mm

Battery:

680 mAh rechargeable Lithium-ion polymer

Water Resistant:

Your Bemo is water resistant. It is safe to wear when dancing in the rain. However, it is not waterproof, so we do not recommend wearing when surfing, kayaking, or anything that could cause complete submersion.

Customer Service:

Have questions? Please call our Customer Service Team at +1 646-454-3200

Warranty:

Please reference the included Important Information Document for the warranty of your country.

More Information

See more possibilities and learn about additional features and options

www.logitech.com/support/bemo



www.logitech.com

© 2014 Logitech. All rights reserved. Logitech, the Logitech logo, and other Logitech marks are owned by Logitech and may be registered. The *Bluetooth*® word mark and logos are registered trademarks owned by Bluetooth SIG, Inc. and any use of such marks by Logitech is under license. All other trademarks are the property of their respective owners. Logitech assumes no responsibility for any errors that may appear in this manual. Information contained herein is subject to change without notice.

620-005087.004