



Ultrathin

Magnetic clip-on
keyboard cover

iK1061
带磁力夹的键盘盖



Setup Guide | 设置指南

Contents / 目录

English.	3	简体中文	12
------------------	---	----------------	----

Know your product

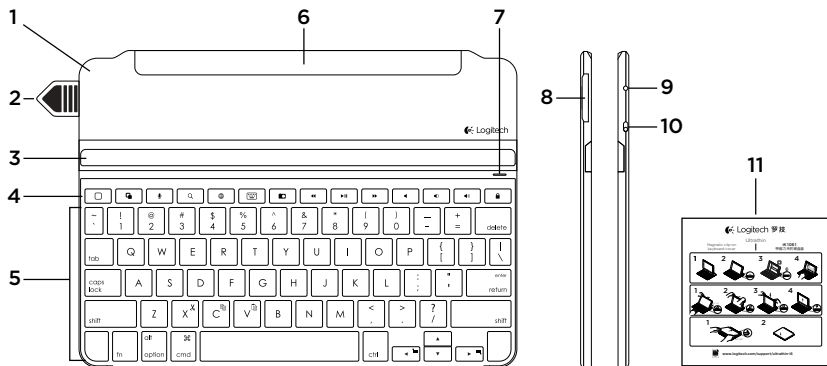

1. Protective cover
2. Battery pull tag
3. Adjustable slot for iPad®
4. Hot keys
5. Keyboard
6. Magnetic clip for attaching to iPad
7. Bluetooth and battery status light
8. Battery holder (two Lithium coin batteries pre-installed)
9. *Bluetooth*® connect button
10. On/off switch
11. Documentation

Set up your product

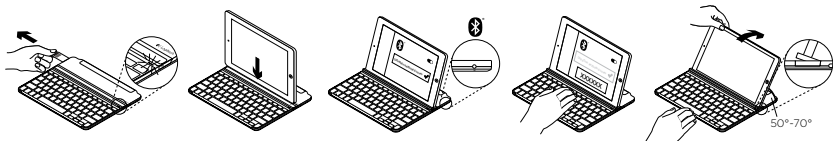

1. Pull out the battery tag.

- Your keyboard powers up. The status light shows solid green for a few seconds.
- Bluetooth discovery starts automatically and continues for 15 minutes. The status light blinks blue (fast blink).
- If the status light turns red, replace the batteries. For more information, see “Replacing your keyboard batteries.”

2. Place your iPad into the slot in the Keyboard Cover.

3. Establish Bluetooth connection:

- On your iPad, make sure Bluetooth is on. Select Settings > Bluetooth > On.
- Select “Ultrathin” from the Devices menu.
- Enter the six digit passkey shown on your iPad screen using your Keyboard Cover, and press Enter.

The status light shows solid blue for a few seconds to confirm that Bluetooth connection is complete.

4. Tilt your iPad to suit your viewing angle. Multiple angles are available to select, from 50° to 70°.

Note:

- You will need to apply downward pressure when you tilt your iPad.
- The maximum weight that can be loaded onto the slot is 5kg.

Hot keys

**Home = iPad Home screen****Switch applications****Siri®**

Use your voice to send messages, make calls, schedule meetings, and more

**Search**

Type keywords in the search bar for contacts, music, notes, events, mail, web, Wikipedia, and more

**Switch language**

Switches the keyboard language

**Virtual keyboard**

Shows/hides the virtual keyboard

**Screen Shot****Previous track****Play/Pause****Next track****Mute****Volume down****Volume up****Lock screen**

Locks or unlocks the iPad screen

Function keys

**Fn + X = Cut****Fn + C = Copy****Fn + V = Paste****Fn + Left cursor = Select left**

Selects text on the left, word by word

**Fn + Right cursor = Select right**

Selects text on the right, word by word

Note:

- To select a function key, press and hold the **Fn** key, and then press the key indicated above.

Use your product

Status light indications

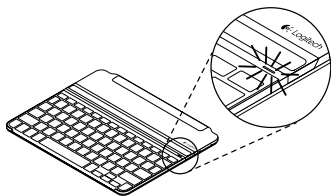

Light	Description
Solid green	Battery power is good (90%-100%).
Solid red	Battery power is low (less than 10%). Replace the batteries.
Blinking blue	Fast: The keyboard cover is in discovery mode, ready for pairing. Slow: The keyboard cover is trying to reconnect to your iPad.
Solid blue	Bluetooth pairing or reconnection is successful.

Connecting to a different iPad

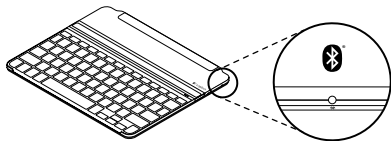

- Place the new iPad into the slot in the Keyboard Cover.
- Make sure the Keyboard Cover is turned on.
- On your iPad, check that Bluetooth is turned on. Select Settings > Bluetooth > On.
- Press the Bluetooth® connect button on the Keyboard Cover. The Keyboard Cover is discoverable for 3 minutes.
- Select "Ultrathin" from the Devices menu.
- Enter the six digit passkey shown on your iPad screen using your Keyboard Cover, and press Enter.

Bluetooth connection is complete.

Detaching your iPad

1. Pull back: Tilt your iPad backwards until it is vertical:

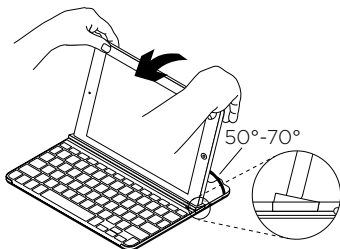

2. Push down: Apply downward pressure to ensure that the slot is completely flat:

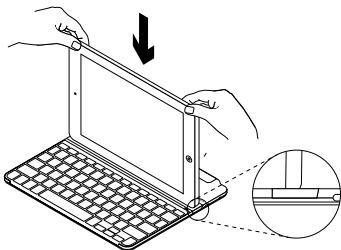

3. Lift iPad: Lift your iPad out of the Keyboard Cover vertically:

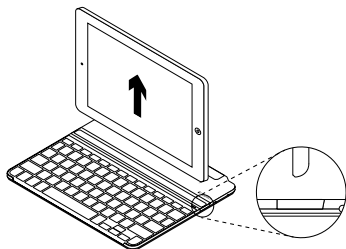

Attaching your iPad to the Keyboard Cover for travel

1. Slide your iPad towards the hinge at the back of the Keyboard Cover. As your iPad gets close to the rear hinge, it pops up:

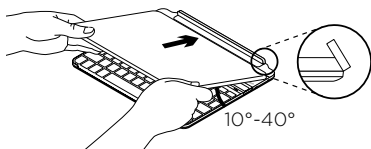

2. Attach your iPad to the rear hinge:

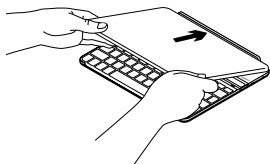

3. Lower your iPad down on to the Keyboard Cover until it closes.

A magnetic clip holds the iPad in position:

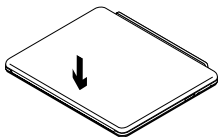

Note:

- **DO NOT** try to slide your iPad into the hinge from the opposite direction:

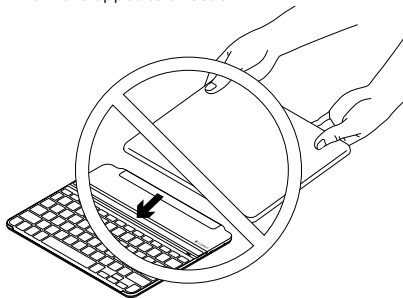

Replacing your keyboard batteries

1. Place your Keyboard Cover face down on a flat surface.
2. Using a fingernail or thumbnail, pry open the battery holder:

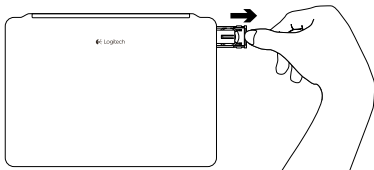

3. Turn your Keyboard Cover over so that the keys are facing upwards, remove the old batteries from the holder and insert new batteries.

4. Close the battery holder:

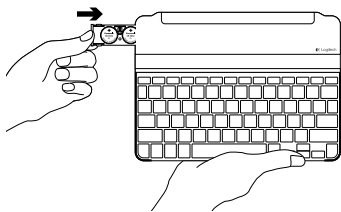

Note: Your Keyboard Cover is provided with two Panasonic CR2032 3V 225mAh Lithium coin batteries pre-installed. These provide two-year battery life, based on two hours usage per day. When your batteries need to be replaced, we recommend that you use Panasonic CR2032 3V 225mAh Lithium coin batteries.

Troubleshooting

The Keyboard Cover does not work

- Press any key to wake the Keyboard Cover from sleep mode.
- Turn the Keyboard Cover Off and then back On.
- If the battery indicator flashes red, replace the batteries.
- Re-establish the Bluetooth connection between the Keyboard Cover and iPad:
 1. On your iPad, check that Bluetooth is turned ON.
 2. Select Bluetooth, locate “Ultrathin” in the Devices list, and remove it. (Click the “i” symbol, and select “Forget this Device”.)
 3. Turn Bluetooth OFF, and then back on. “Ultrathin” should NOT be displayed in the Devices list.
 4. Press the Bluetooth connect button on the Keyboard Cover.
 5. Select “Ultrathin” from the Devices menu.
 6. Enter the six digit passkey shown on your iPad screen using your Keyboard Cover, and press Enter.

My iPad doesn't fit into the slot

- Make sure you are inserting your iPad on its side into the slot, with the Home key on the right hand side. (The Keyboard Cover does not support portrait mode.)
- Make sure you are using your keyboard cover with an iPad only, and not with any other covers or thick glass protectors.

Visit Product Support

There's more information and support online for your product. Take a moment to visit Product Support to learn more about your new Bluetooth keyboard.

Browse online articles for setup help, usage tips, and information about additional features. If your Bluetooth keyboard has optional software, learn about its benefits and how it can help you customize your product.

Connect with other users in our Community Forums to get advice, ask questions, and share solutions.

At Product Support, you'll find a wide selection of content including:

- Tutorials
- Troubleshooting
- Support community
- Online documentation
- Warranty information
- Spare parts (when available)

Go to:

www.logitech.com/support/ultrathin-i6

What do you think?

Thank you for purchasing our product.
Please take a minute to tell us what you think of it.

www.logitech.com/ithink

了解您的产品

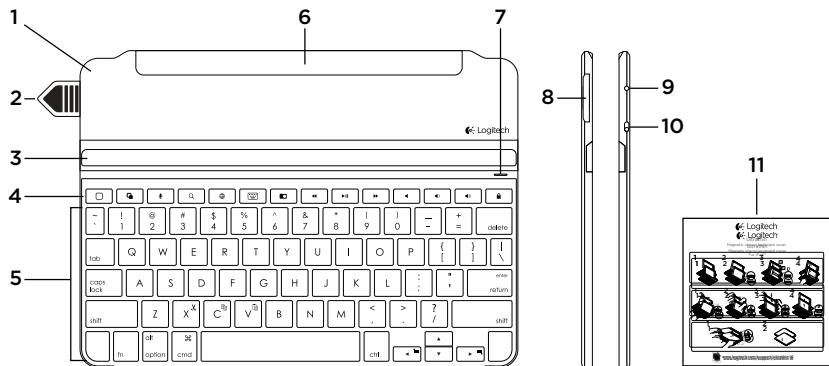

1. 保护盖
2. 电池拉带
3. iPad 用可调节插槽
4. 热键
5. 键盘
6. 固定 iPad 用磁力夹
7. 蓝牙和电池状态指示灯
8. 电池架 (已预装两节纽扣型锂电池)
9. 蓝牙™ 连接按钮
10. 开启/关闭开关
11. 文档

设置您的产品

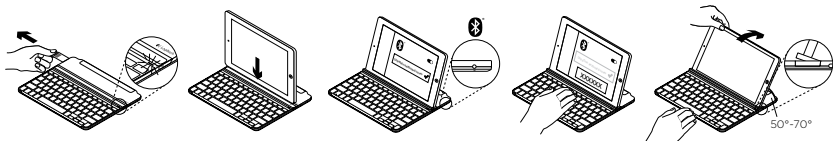

1. 拉出电池带。

- 键盘接通电源。状态指示灯亮起稳定绿灯并持续数秒。
- 蓝牙搜索功能自动开启，将持续 15 分钟。状态指示灯闪烁蓝灯（快速闪烁）。
- 如果状态指示灯短暂变为红灯，请更换电池。有关详细信息，请参见“更换键盘电池”。

2. 将 iPad 插入键盘盖的插槽中。

3. 建立蓝牙连接：

- 确保 iPad 的蓝牙功能已开启。依次选择：“设置” > “蓝牙” > “开启”。
- 在“设备”菜单中选择“Ultrathin”。
- 使用键盘盖输入 iPad 屏幕上显示的六位万能钥匙，然后按 Enter 键。

状态指示灯亮起数秒钟的稳定蓝灯，确认已建立蓝牙连接。

4. 调整 iPad 至适合观看的角度。可调角度范围：50° 至 70°。

请注意：

- 转动 iPad 时，您需要向下按压。
- 插槽可承受的最大重量为 5kg。

热键

**Home = iPad 主屏幕****切换应用程序****Siri®**

通过语音发送消息、拨打电话、安排会议等

**搜索**

在搜索栏中输入关键字以搜索联系人、音乐、注释、事件、邮件、网站、维基百科等内容

**切换语言**

切换键盘语言

**虚拟键盘**

显示或隐藏虚拟键盘

**截屏****上一曲目****播放/暂停****下一曲目****静音****调低音量****调高音量****锁屏**

锁定或解锁 iPad 屏幕

功能键

**Fn + X = 剪切****Fn + 左光标 = 选择左侧内容**
逐字选择左侧文本**Fn + C = 复制****Fn + 右光标 = 选择右侧内容**
逐字选择右侧文本**Fn + V = 粘贴**

请注意：

- 要选择功能键，请按住 **Fn** 键，然后按上方显示的键。

使用您的产品

状态指示灯

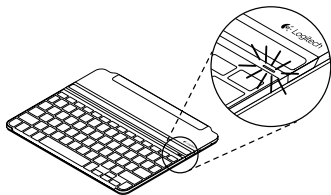

指示灯	说明
稳定绿灯	电池电量充足 (90%-100%)。
稳定红灯	电量不足 (<10%)。更换电池。
闪烁蓝灯	快速：键盘盖处于可被搜索状态，已准备好可以进行配对。 缓慢：键盘盖正在尝试重新连接 iPad。
稳定蓝灯	蓝牙配对或重新连接成功。

连接另一个 iPad

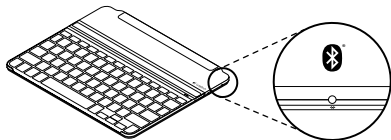

1. 将新的 iPad 插入键盘盖的插槽中。
2. 确保键盘盖处于开启状态。
3. 确认 iPad 的蓝牙处于开启状态。
依次选择：“设置”>“蓝牙”>“开启”。

4. 按下键盘盖上的蓝牙™ 连接按钮：键盘盖在 3 分钟内将处于可被搜索状态。
5. 在“设备”菜单中选择“Ultrathin”。
6. 使用键盘盖输入 iPad 屏幕上显示的六位万能钥匙，然后按 Enter 键。
蓝牙连接已建立。

卸下 iPad

1. 将 iPad 拉回：向后转动 iPad 直到其呈垂直角度：
3. 提起 iPad：将 iPad 从键盘盖中垂直提起：

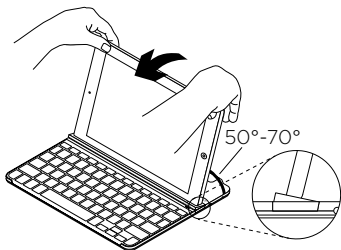

2. 向下按压 iPad，确保插槽处的平整：

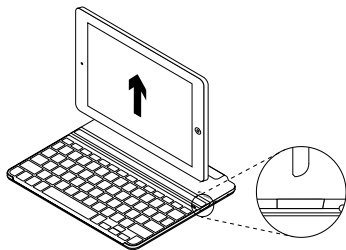
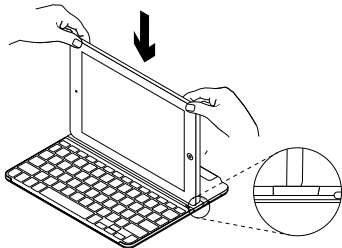

旅行时将 iPad 连接至键盘盖

1. 将 iPad 滑向键盘盖后部的转轴。
当 iPad 靠近后部转轴时，转轴会弹出：

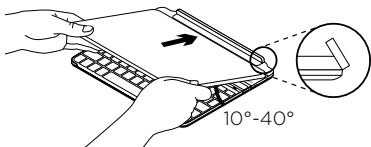

2. 将 iPad 固定到后部转轴上：

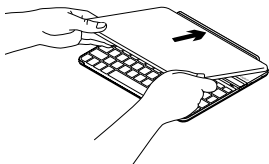

3. 将 iPad 向下贴紧键盘盖直至闭合。
磁力夹将把 iPad 固定到位：

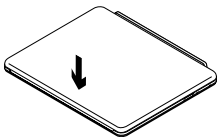

请注意：

- 请勿将 iPad 从相反方向滑入转轴：

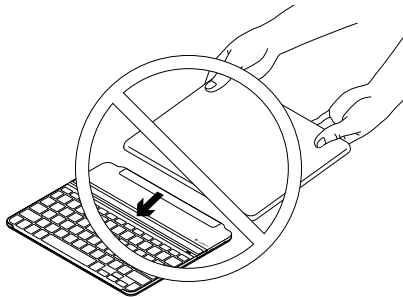

更换键盘电池

1. 将键盘盖面朝下放置于平坦表面。
2. 用手指甲或拇指指甲挑开电池架：

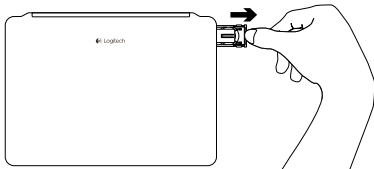

3. 将键盘盖改为面朝上放置，从支架中取出旧电池并插入新电池。

4. 关闭电池架：

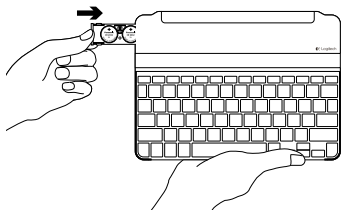

请注意：您的键盘盖预装有两节 Panasonic CR2032 3V 225mAh 钮扣型锂电池。每天使用两小时的情况下，电池寿命可达两年。

如果您的电池需要更换，建议仍使用 Panasonic CR2032 3V 225mAh 钮扣型锂电池。

疑难解答

键盘盖不工作

- 按任意键即可将键盘盖从休眠模式中唤醒。
- 将键盘盖关闭，然后再将其重新开启。
- 如果电池指示灯闪烁红灯，请更换电池。
- 在键盘盖与 iPad 之间重新建立蓝牙连接。
 1. 确认 iPad 的蓝牙处于开启状态。
 2. 选择“蓝牙”，在“设备”列表中找到“Ultrathin”并将其移除。(单击“i”标志，并选择“忽略此设备”。)
 3. 将蓝牙关闭，然后再将其重新开启。“Ultrathin”应不再显示于“设备”列表中。
 4. 按下键盘盖上的蓝牙连接按钮。
 5. 在“设备”菜单中选择“Ultrathin”。
 6. 使用键盘盖输入 iPad 屏幕上显示的六位万能钥匙，然后按 Enter 键。

我的 iPad 无法插入插槽

- 请确保您是将 iPad 的横边插入插槽，Home 键位于其右侧。(键盘盖不支持纵向模式。)
- 确保仅将键盘盖与 iPad 配合使用，并且不使用任何其他保护盖或厚玻璃保护装置。

访问“产品支持”

我们的网站提供有关于本产品的详细信息和支持服务。请抽时间访问“产品支持”，了解关于新蓝牙键盘的更多信息。

浏览在线文章，查看安装帮助、使用技巧以及关于更多功能的信息。如果蓝牙键盘有可选软件，请了解其优点以及如何帮助对键盘进行自定义。

通过“社区论坛”与其他用户交流，获得建议，提出问题，分享解决方法。

“产品支持”提供了广泛的内容选择：

- 教程
- 疑难解答
- 支持社区
- 在线文档
- 保修信息
- 备用部件 (若有供应)

访问：

www.logitech.com/support/ultrathin-i6

您对本产品有何感想？

感谢您购买罗技产品。
请拨冗告诉我们您的意见。

www.logitech.com/ithink



www.logitech.com

www.logitech.com/support/ultrathin-i6

© 2014 Logitech. All rights reserved. Logitech, the Logitech logo, 罗技, and other Logitech marks are owned by Logitech and may be registered. Apple, iPad, and Siri are trademarks of Apple Inc., registered in the U.S. and other countries. The *Bluetooth*® word mark and logos are registered trademarks owned by Bluetooth SIG, Inc. and any use of such marks by Logitech is under license. All other trademarks are the property of their respective owners. Logitech assumes no responsibility for any errors that may appear in this manual. Information contained herein is subject to change without notice.

版权所有 © 2014 年罗技。罗技、罗技标志、Logitech 和其他罗技商标均归罗技所有，并或已注册。Apple 和 iPad 是 Apple Inc. 在美国和其他国家注册的商标。蓝牙™ 文字标志为 Bluetooth SIG, Inc. 所有的注册商标，罗技对此类标志的所有使用均已获得授权。所有其它商标均是其各自所有者的财产。罗技对于本手册中可能出现的任何错误不承担任何责任。本手册中包含的信息如有更改，恕不事先通知。

621-000416.002