

logitech®

# SMARTER THAN THE AVERAGE DOCK.



## Logitech SmartDock

Logitech® SmartDock is an AV Control Console that revolutionizes the Skype® for Business collaboration experience. Simply walk into a conference room and start your meeting with one-touch join.

Designed in partnership with Microsoft®, SmartDock enables expanded I/O for Surface® Pro 4 that includes support for dual HDMI displays<sup>1</sup>, three USB 3.1 ports and Gigabit

Ethernet, allowing the IT administrator to connect recommended devices, such as Logitech ConferenceCams. An embedded motion sensor activates the system when anyone enters the room. Content sharing from a laptop is a snap with 1080p60 HDMI input and capture. With the optional extender box, a single 5m cable with HDMI, USB, LAN and power provides a clean and streamlined

installation on the conference table. The pivoting, cast-metal base provides enhanced security for Surface Pro 4. The combination of tamper-resistant screws and a K-lock ensures that the tablet is always in place and ready for your meeting.

With SmartDock, pure elegance meets total control to enable consistently remarkable Skype for Business collaboration.

# Logitech SmartDock



SmartDock

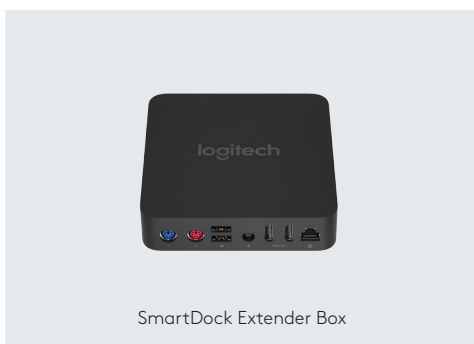

SmartDock Extender Box

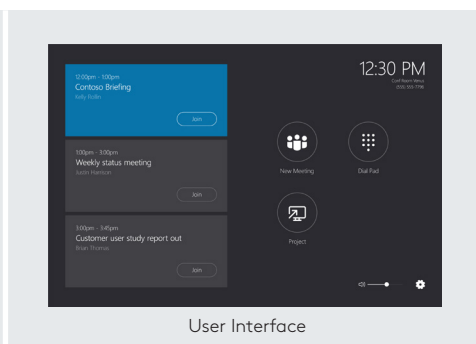

User Interface

## FEATURES & BENEFITS

### AV console

SmartDock and Microsoft Surface Pro 4 optimize the Skype for Business collaboration experience in meeting spaces. Leave your laptop at your desk, walk into any meeting space, and start an optimized Skype for Business video conference with one-touch join.

### Powered, secure mount for Surface Pro 4

Tamper-resistant screws and a K-lock provide enhanced security and help ensure that Surface Pro 4 is always in place, charged, and ready for the most important meeting—yours!

### Pivoting, cast-metal support platform

The sturdy, elegantly designed base provides a premium mount for Surface Pro 4 with elegant industrial design.

### Extended I/O for Surface Pro 4

Supports a wide variety of deployments and device connectivity with dual 1080p display ports<sup>1</sup>, an HDMI input for 1080p60 content sharing, three USB 3.1 type A ports, Gigabit Ethernet, and a headset mini-plug.

### IR motion sensor

Conveniently wakes the system when motion is detected in the meeting space and enables energy saving hibernation mode when the room is empty.

### Streamlined deployment

An optional extender box combines HDMI, USB, LAN and power cords into a single 5m cable for a clean, clutter-free installation on the conference table.

### Integrated support for Logitech GROUP in optional Extender Box

When used with Logitech GROUP, SmartDock Extender Box eliminates the need for the GROUP hub, power supply and associated cables.

### Designed in partnership with Microsoft

Close collaboration between Logitech and Microsoft ensures full and seamless integration with Surface Pro 4 and Skype for Business.

### Plug-and-play camera setup

Simply connect camera to powered hub with 4.9m/16' cable provided to get up and running in a snap.

### SmartDock works with all Logitech ConferenceCams

SmartDock works with a wide range of meeting room AV devices. All Logitech ConferenceCams work with SmartDock.

### Optimized for Skype for Business

SmartDock provides a low-cost, high-quality Skype for Business collaboration experience in shared meeting spaces.

## PRODUCT SPECIFICATIONS

### SmartDock

Price: RM 3599.00  
Part #: 960-001110  
UPC: 097855125095

### Extender Box

Price: RM 1499.00  
Part #: 960-001095  
UPC: 097855125118

Pricing excludes Microsoft Surface Pro 4<sup>2</sup> and Skype for Business meeting room client.

## PRODUCT DIMENSIONS + WEIGHT

### SmartDock

239 x 334 x 209mm  
9.4 x 13.2 x 8.2"  
2738g/6.04lb

### Extender Box

34 x 128 x 128mm  
1.3 x 5.0 x 5.0"  
360g/0.79lb

### Cable Length

HDMI: 3m/9.8'  
Network: 3m/9.8'  
Power: 3m/9.8'  
Extender Box: 5m/16.4'

## INSIDE THE BOX

### SmartDock

Power Supply  
Ethernet cable  
Two HDMI cables  
Assembly tools  
Documentation  
Logitech SmartDock

### SmartDock Extender Box

5m/16ft Extender Cable  
VESA Mounting Plate 100x100mm  
Hook and loop pads  
Documentation  
Logitech SmartDock Extender Box

### SmartDock + Extender Box

All components included with Logitech SmartDock and Logitech SmartDock Extender Box

## SYSTEM REQUIREMENTS

Microsoft Surface Pro 4 with Skype for Business meeting room client  
Skype for Business Account  
Ethernet  
External Display with HDMI input  
100-240v AC Power

## CERTIFICATIONS

### SmartDock

Windows 10  
FCC  
UL

### Extender Box

Windows 10  
FCC  
UL

## WARRANTY

2-year limited hardware

[www.logitech.com/SmartDock](http://www.logitech.com/SmartDock)

B15-02, PJ Trade Center,  
No 8, Jalan PJU 8/8A,  
Damansara Perdana,  
47820 PJ, Selangor  
Malaysia.

Published September 2016

<sup>1</sup> When supported by Microsoft.

<sup>2</sup> Contact your channel reseller for pricing information.

<sup>3</sup> For bundle options with a Logitech ConferenceCam, contact your channel reseller.

© 2016 Logitech. Logitech, the Logitech logo and other Logitech marks are owned by Logitech and may be registered.

All other trademarks are the properties of their respective owners. Logitech assumes no responsibility for any errors that may appear in this publication. Product, pricing and feature information contained herein is subject to change without notice.