

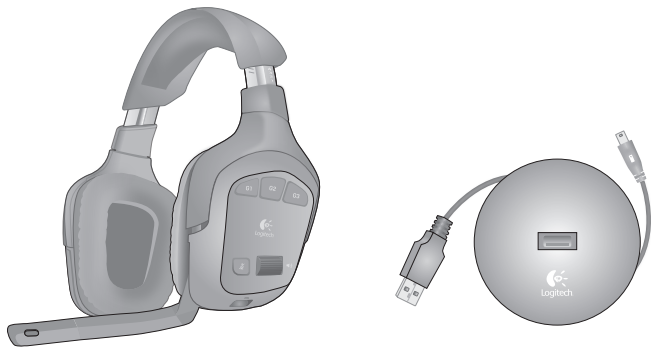

Logitech® Wireless Gaming Headset G930
罗技® 无线游戏耳机麦克风 G930

Setup Guide
设置指南





Contents / 目录

English	4
简体中文	11
www.logitech.com/support	19

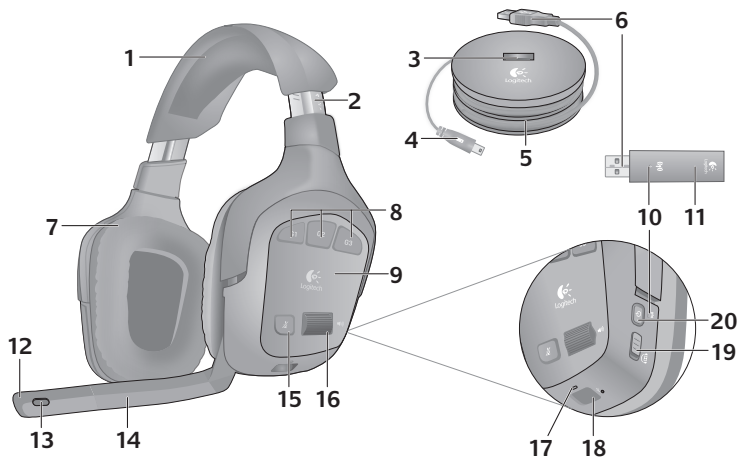

- | | | |
|----------------------------------|--|----------------------------|
| 1. Memory foam headband pad | 9. Closed-back, noise-isolating ear cups | 15. Microphone mute button |
| 2. Precision headband adjustment | 10. Wireless status light | 16. Volume roller |
| 3. Wireless adapter dock | 11. Wireless adapter | 17. Battery status light |
| 4. Charging cable | 12. Microphone mute light | 18. Charging port |
| 5. Charging base | 13. Noise-canceling microphone | 19. Surround sound switch |
| 6. Full-speed USB connection | 14. Flexible, rotating microphone boom | 20. Power button |
| 7. Plush ear pads | | |
| 8. Programmable G-keys | | |

1

www.logitech.com/support/g930



Install the headset G930 software to enable 7.1 surround sound, G-key configuration, and voice morphing.

2

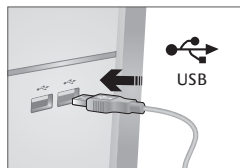

Connect wireless adapter to the charging base. Connect the charging base to a USB port on your computer. Place the charging base in an open, unobstructed area on your desk.

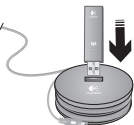

Note: Your headset can work up to 40 feet away from the wireless adapter. Walls, metal objects and other wireless devices may reduce wireless performance.

3

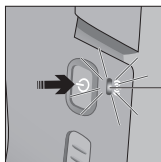





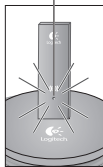

Press the power button to turn on the headset and establish a wireless connection.

Note: The headset comes with a limited charge out of the box. Fully charge the headset before extensive use.



Wireless status light (())

Steady green	 	Connection made; headset ready to use
Flashing green	 	Headset out of range
No light		Headset powered off
No light		No connection to headset

Note: The headset connects only to the included USB wireless adapter.

4

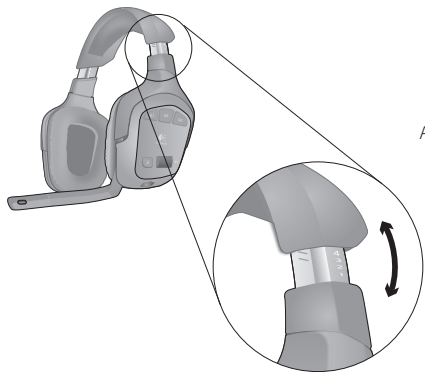

Adjust the headband for a comfortable fit.

5



Place the microphone about an inch away from the corner of your mouth for optimal voice clarity.

Controls

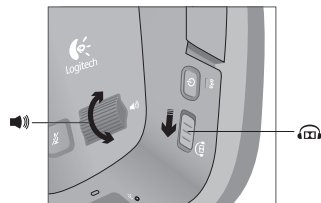

Use the G930 software to program the G-keys. Here are examples of popular actions assigned to G-keys.

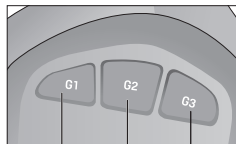

Media controls 

 Slide the surround sound switch down to turn on this feature. You must install the included software to activate surround sound.

Voice morphing



 Adjust headset volume using the volume roller.

Push to talk



 Mute the microphone by rotating the microphone boom to its up position or pressing the microphone mute button. The microphone mute light illuminates when the microphone is muted.

Charging

The internal rechargeable battery gives you up to 10 hours of play time on a full charge. A full charge can take up to two and a half hours. Headset can charge while in use.

Battery status light 	
Green	More than 1 hour of play time left
Red	Less than 1 hour of play time left
Flashing orange	Headset charging
Steady orange	Charging complete
No light	Headset off or no charge remaining

Note: Battery status is also shown in the G930 software.

Note: The headset will play an audible warning when the battery is low. This can be turned off in the software.

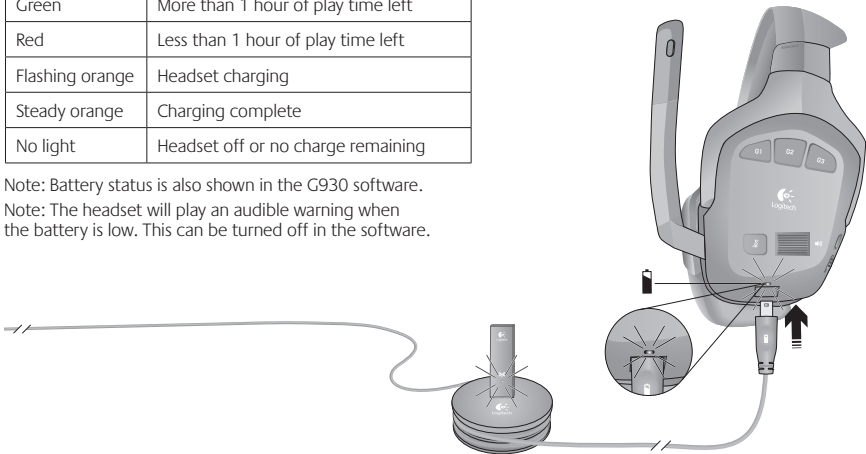

Rechargeable battery is removable for disposal and recycling. Replacement battery available online. See *Important Information* and www.logitech.com/support/G930 for more information.

G930 software



- | | |
|-------------------------|-----------------------------|
| 1. Audio levels | 5. Voice morphing |
| 2. Advanced equalizer | 6. Surround sound mixer |
| 3. G-keys customization | 7. Settings and user manual |
| 4. Battery status | |

Note: To learn more about your software's features, check out the digital user's manual in the software.

Audio tips

- For the best listening experience, configure your game or media player audio setting to 7.1 or 5.1 surround sound output, if available. Avoid using settings labeled “headphones” because they do not output surround sound.
- For surround sound playback with movies, ensure your media player has the proper Dolby® or DTS® codecs to output surround sound.
- Use the sidetone setting in the G930 software for a more natural speaking experience by controlling the loudness of your voice back into the headset. This feature does not affect how others hear you.
- Use the advanced equalizer in the software to fine-tune audio playback response.

General-use tips

- For optimal wireless performance, plug the wireless receiver into the charging base and place in an open, unobstructed area on your desk. Avoid connecting the wireless receiver to keyboards or monitors, in back of desktop towers, or near other wireless receivers or Wi-Fi routers.
- To charge the headset when your PC is sleeping or off, your PC must power the USB ports in those states. If it does not, adjust your PC power management options to keep your PC on and awake when you want to charge the headset.
- If an application is not recognizing the headset, try quitting the application and relaunching it.
- To get the most from your G930 headset, read the digital user manual found in the software. You can also visit www.logitech.com/support/G930 for more product support.
- To turn off the headset, press and hold the power button for two seconds.



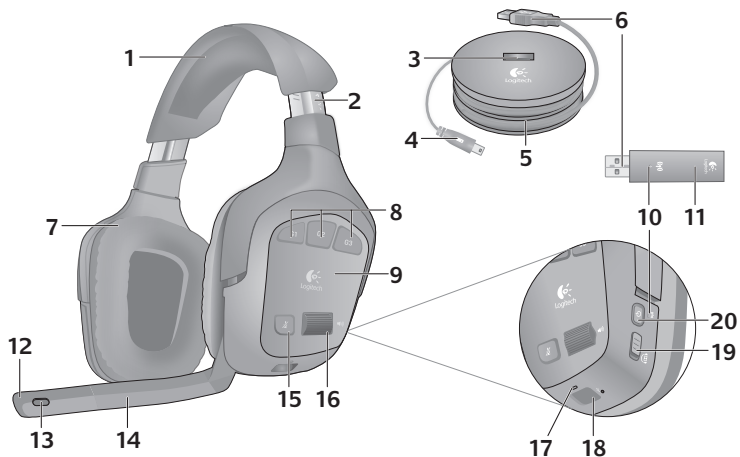

- | | | |
|--------------|-------------------|-------------|
| 1. 记忆棉头带垫 | 8. 可编程 G 键 | 15. 麦克风静音按钮 |
| 2. 精确头带调整 | 9. 具备噪音消除功能的封闭式耳罩 | 16. 音量旋钮 |
| 3. 无线适配器底座 | 10. 无线状态指示灯 | 17. 电池状态指示灯 |
| 4. 充电连接线 | 11. 无线适配器 | 18. 充电端口 |
| 5. 充电底座 | 12. 麦克风静音指示灯 | 19. 环绕声开关 |
| 6. 全速 USB 连接 | 13. 具备噪音消除功能的麦克风 | 20. 电源按钮 |
| 7. 舒适耳垫 | 14. 可调式旋转麦克风杆 | |

1

[www.logitech.com/
support/g930](http://www.logitech.com/support/g930)



安装耳机麦克风 G930 软件启用
7.1 环绕声、G 键配置和语音转换功能。

2

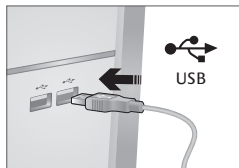

将无线适配器连接至充电底座。将充电底座连接至电脑的 USB 端口上。将充电底座放在桌面上开放、无障碍的区域。

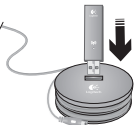

注意：耳机麦克风可在距无线适配器 40 英尺的范围内工作。墙壁、金属物体和其他无线设备可能会降低无线性能。

3

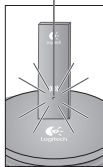
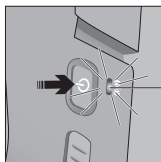

按电源按钮开启耳机麦克风，建立无线连接。

注意：开箱时耳机麦克风电量有限。在正常使用前请将耳机麦克风充满电。

无线状态指示灯 (📶)

稳定绿灯	📶	已连接；耳机麦克风已准备就绪，可供使用
闪烁绿灯	📶	耳机麦克风超出无线连接范围
无指示灯	📶	耳机麦克风已关闭
无指示灯	📶	未连接至耳机麦克风

注意：耳机麦克风仅能连接至内置的 USB 无线适配器。

4



调整头带以获得最佳舒适体验

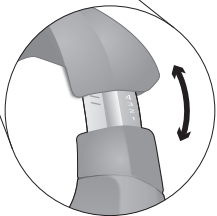



5

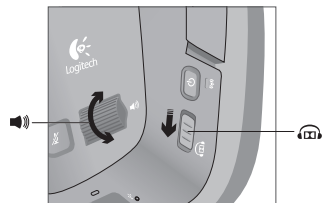

将麦克风放到离嘴角大约一英寸的位置以获得最佳语音清晰度。

控制键



 向下滑动环绕声开关以启用此功能。您需要安装随附的软件以激活环绕声。

 使用音量旋钮调整耳机麦克风音量。

使用 G930 软件设定 G 键。以下为指定给 G 键的常见操作示例。

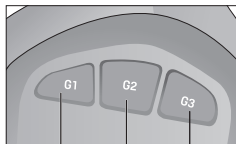

媒体控制键   

语音转换   

按住说话   



 将麦克风杆转到上面位置或按下麦克风静音按钮设定静音。当麦克风静音时，麦克风静音指示灯亮起。

正在充电

内置可充电电池充满电可支持 10 小时的使用时间。充满电需要两个半小时。耳机麦克风可在使用时进行充电。

电池状态指示灯 	
绿灯	剩余使用时间超过一小时
红灯	剩余使用时间少于一小时
闪烁橙色灯	耳机麦克风正在充电
稳定橙色灯	充电完毕
无指示灯	耳机麦克风关闭或无剩余电量

注意：电池状态也显示在 G930 软件中。

注意：电池电量低时，耳机麦克风会发出音响警告声。可以在软件中将其关闭。

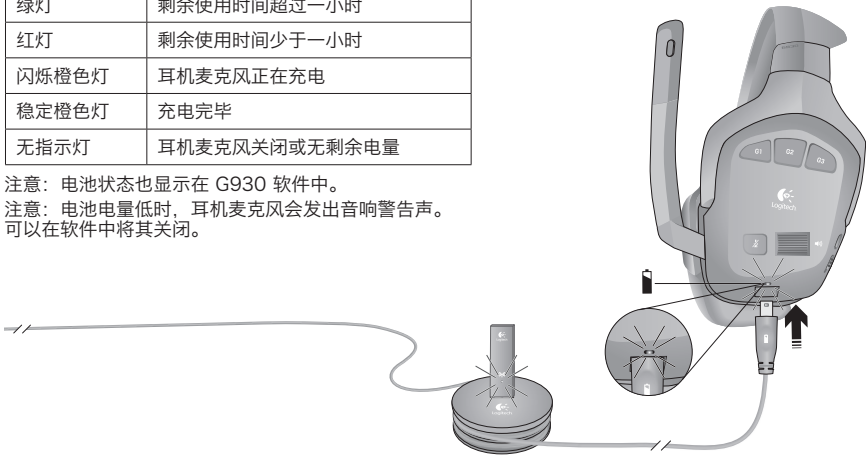

可充电电池可以拆卸以进行回收处理。可在线更换电池。有关详细信息，请查看重要信息并访问网站 www.logitech.com/support/G930。

G930 软件



1. 音频电平
2. 高级均衡器
3. G 键自定义
4. 电池状态
5. 语音转换
6. 环绕声混音器
7. 设置和用户手册

注意：如欲了解更多关于软件功能的信息，请查看软件中的数字用户手册。

音频提示

- 为了获得最佳听觉体验，如可用，请将游戏或媒体播放器音频设置为 7.1 或 5.1 环绕声输出。避免使用标签为“耳机麦克风”的设置，因为它们不能输出环绕声。
- 如需感受电影环绕声播放，请确保您的媒体播放器带有可以输出环绕声的 Dolby® 或 DTS® 编解码器。
- 使用 G930 软件侧音设置，通过控制耳机麦克风说话声音大小获得自然说话体验。该功能不会影响其他人听您的讲话。
- 使用软件中的高级均衡器调整音频播放响应。

常用提示

- 为了获得最佳无线性能，请将无线接收器插到充电底座上，并将充电底座放在桌面上开放、无障碍的区域。避免将无线接收器连接至键盘或显示器，或将其放置于台式机背面或靠近其他无线接收器或 Wi-Fi 路由器的地方。
- 当 PC 睡眠或关机时，如想给耳机麦克风充电，请确保您 PC 的 USB 端口在这两种状态下都通电。如端口不通电，当您想给耳机麦克风充电时，请调整 PC 电源管理选项，保持 PC 开机并处于唤醒状态。
- 如果应用程序不能识别耳机麦克风，尝试退出并重启程序。
- 您可通过阅读软件中的数字用户手册以充分利用 G930 耳机麦克风。如欲了解更多产品支持，还可访问 www.logitech.com/support/G930。
- 按住电源按钮两秒可关闭耳机麦克风。



www.logitech.com/support

Table of Toxic and Hazardous Substances/Elements and their Content

产品中有毒有害物质或元素的名称及含量
根据中国<<电子信息产品污染控制管理办法>>

Head Set 耳机麦克风						
有毒有害物质或元素						
部件名称	铅 (Pb)	汞 (Hg)	镉 (Cd)	六价铬 (Cr(VI))	多溴联苯 (PBB)	多溴二苯醚 (PBDE)
电缆 Cable	X	○	○	○	○	○
电路板组件 PWAs	X	○	○	○	○	○
塑料外壳 Plastic enclosure	○	○	○	○	○	○
塑料部件 Plastic parts	○	○	○	○	○	○
金属部件 Metal parts	X	○	○	○	○	○
Speaker 音箱						
有毒有害物质或元素						
部件名称	铅 (Pb)	汞 (Hg)	镉 (Cd)	六价铬 (Cr(VI))	多溴联苯 (PBB)	多溴二苯醚 (PBDE)
电缆 Cable	X	○	○	○	○	○
电路板组件 PWAs	X	○	○	○	○	○
塑料部件 Plastic parts	○	○	○	○	○	○
木制部件 Wood parts	○	○	○	○	○	○
金属部件 Metallic elements	X	○	○	○	○	○
<p>O = 表示该有毒有害物质在该部件所有均质材料中的含量均在 SJ/T11363-2006 标准规定的限量要求以下。 X = 表示该有毒有害物质至少在该部件的某一均质的含量超出 SJ/T11363-2006 标准规定的限量要求。</p> <p>表中标有“X”的所有部件都符合欧盟 RoHS 法规</p> <p>“欧洲议会和欧盟理事会 2003 年 1 月 27 日关于电子电器设备中限制使用某些有害物质的 2002/95/EC 号指令”</p> <p>注：环保使用期限的参考标取决于产品正常工作的温度和湿度等条件</p>						



www.logitech.com

© 2013 Logitech. Logitech, the Logitech logo, and other Logitech marks are owned by Logitech and may be registered. Microsoft, Windows Vista, Windows, and the Windows logo are trademarks of the Microsoft group of companies. Mac and the Mac logo are trademarks of Apple Inc., registered in the U.S. and other countries. Manufactured under license from Dolby Laboratories. Dolby, Pro Logic, and the double-D symbol are registered trademarks of Dolby Laboratories. All other trademarks are the property of their respective owners. Logitech assumes no responsibility for any errors that may appear in this manual. Information contained herein is subject to change without notice.

版权所有 ©2013 年罗技。罗技、罗技标志、Logitech 和其他罗技商标均归罗技所有，并已注册。Microsoft、Windows Vista、Windows 和 Windows 标志是 Microsoft 集团公司的商标。Mac 和 Mac 图标是 Apple Inc. 在美国和其他国家注册的商标。Dolby Laboratories 授权制造。Dolby、Pro Logic 和双 D 标志是 Dolby Laboratories 的商标。所有其它商标均是其各自所有者的财产。罗技对于本手册中可能出现的任何错误不承担任何责任。本手册中包含的信息如有更改，恕不事先通知。

620-005016.003