

ZEROTOUCH

User Guide

TO GET STARTED

1

Download the app on Google Play Store

Works with Android™ 5.0 or later



[Download here](#)

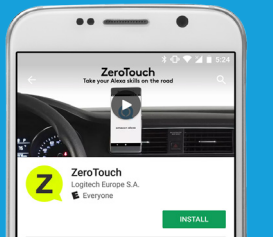

2

Launch the ZeroTouch App for step-by-step instructions

You'll learn to:

- Pick a metal adapter
- Place the mount in your car
- Pair your phone to the mount
- Wake-up the app
- Customize app preferences and features

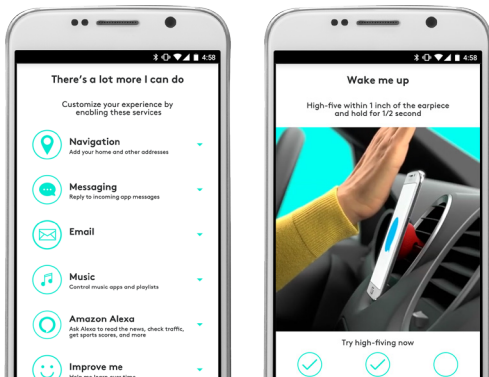

3

Use ZeroTouch with some of our favorite commands

"Alexa, tell me a joke"

"Text John"

"Navigate home"

"Play jazz"

"Call Mom"

"Email Lisa"

NEED SUPPORT? LET US HELP YOU



Email our team directly:

ZeroTouchHelp@logitech.com



Call customer support:

+1 646-454-3200 Monday - Friday: 6:00 a.m. - 6:00 p.m. (PT)



Watch help videos:

<http://bit.ly/2nnWIMg>

logitech®

CHOOSING A METAL ADAPTER



- We recommend using the pill-shaped adapter on the outside of your phone or case:
1. Read below to figure out the best placement for the adapter.
 2. To attach, clean the back of your phone or case where you plan on sticking the adapter.
 3. In a room temperature environment, place and hold the adapter down for 60 seconds to adhere.

A

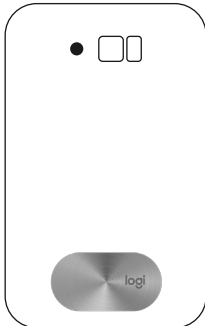

If you use wireless charging...

Place the metal adapter outside of the charging area.

B



If your phone has a magnetic sensor...

Using your mount, find a place on the back of your phone where the mount's magnet does not put your phone to sleep.

C

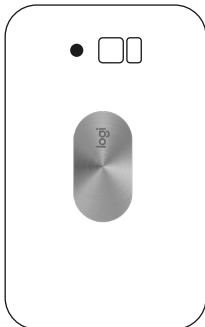

If A or B does not apply...

Place the adapter vertically in the middle of your phone.



If you use a case less than 2mm thick, you can also use the round adapter in between the phone and case, like the illustration on the left.

Note: If you have a case with a textured back (fabric, rhinestones, etc.), it may not work with either adapter. Try using a smooth, thinner case or use the pill-shaped adapter on your phone and dock without the case on.

[Watch a video on how to place your adapter](#)

WHAT TO SAY

General Commands

- "Cancel"**
Ends the current flow
- "Repeat"**
Says the last prompt or message again
- "Change" or "Go back"**
Modifies your message or the last thing you said

Messaging

- "Text Amy"**
Initiates a text message to Amy
- "Text John I'll be there soon"**
Initiates a text message to John with the message "I'll be there soon"
- "Read messages"**
Speaks your unheard messages since docking
- "Read last message"**
Speaks most recent message.
- "Read last message from Amy"**
Re-reads Amy's most recent message

Music

- "Play music"**
Resumes most recent music app
- "Play Jazz on Pandora"**
Plays Jazz station on Pandora
- "Play Hello by Adele"**
Plays this specific song
- "Put on my Party playlist"**
Plays a specific playlist
- "Pause"**
Pauses current song
- "Skip"**
Starts next song

Alexa

- "Alexa, what's the weather today?"**
Provides weather information in the location you specify
- "Alexa, set an alarm for 3pm"**
Sets an alarm for you at the specified time
- "Alexa, what's my News Flash?"**
Announces flash briefing for the day

Navigation

- "Share my location with Chase"**
Sends a link with your real-time location
- "Take me home"**
Provides directions to your saved locations like home
- "Directions to 165 Post St"**
Search for addresses in nearby cities
- "Find Mexican food"**
Provides suggestions for Mexican Food nearby

Calendar

- "What's on my calendar today?"**
Announces all events on your calendar for today
- "What's on my calendar this Friday?"**
Announces all events in agenda
- "Accept," "Decline," "Maybe"**
RSVP to an email calendar invite

Calling

- "Call Brian"**
Dials Brian on speakerphone
- "Call Amy at work"**
Dials Amy's work number on speakerphone

Email

- "Read email"**
Announces your unheard emails since docking
- "Send email"**
Initiates an email message to compose

Using the hand wave gesture:

- "Repeat"**
Re-starts email read back
- "Reply"**
Interrupts email read back and initiates email reply composition
- "Skip"**
Terminates read back of current email and reads next unread email
- "Continue"**
Continues email read back from where last left off