

ZONE WIRELESS RECEIVER

Complete Setup Guide
Guide d'installation complet

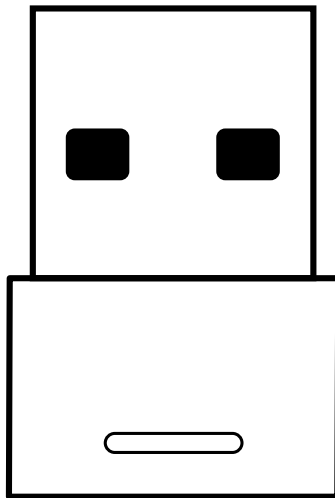

CONTENTS

English3

Français6

Español9

Português 12

KNOW YOUR PRODUCT

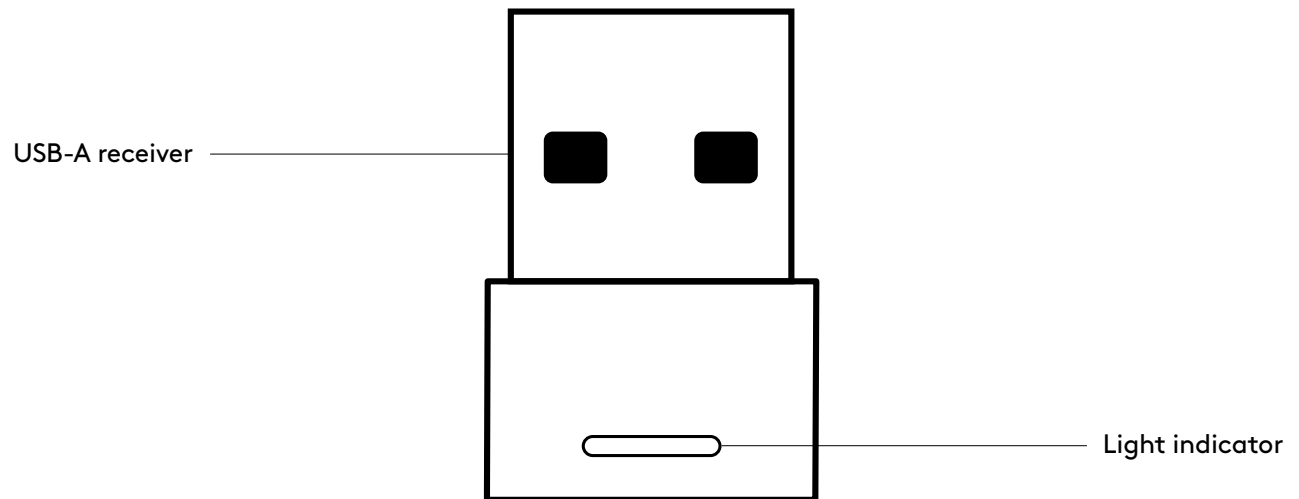

WHAT'S IN THE BOX

USB-A receiver

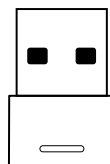

CONNECTING THE RECEIVER TO THE HEADSET

- Insert the receiver into the computer USB-A port.
 - Insert the receiver into the USB-C adapter. Then insert the adapter into the computer USB-C port.

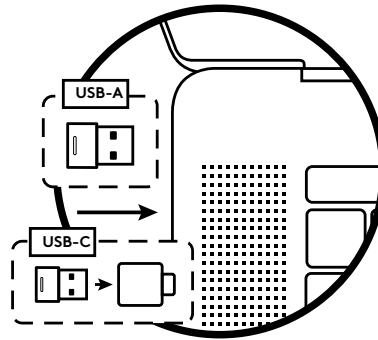

- Install and open Logi Tune Desktop. Download it from www.logitech.com/logitune

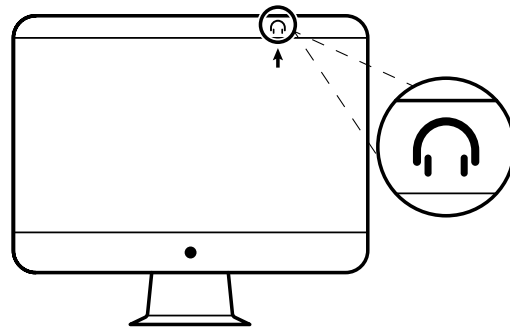

- Logi Tune Desktop will confirm that a new receiver is found. Enter pairing mode on headset by pressing the power button for 3 seconds. Click **Continue**.

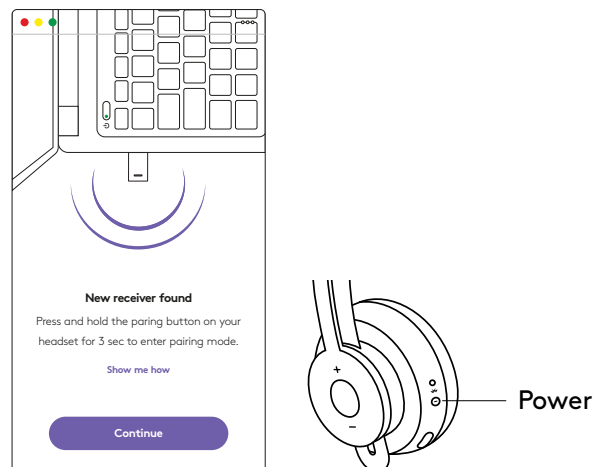

4. If pairing mode is successful, light indicators on the receiver and headset will flash white.

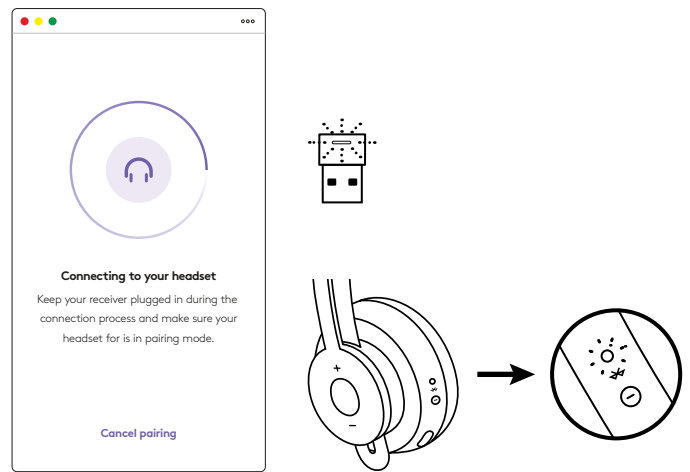

5. Once you see this screen, the receiver is now paired with the headset. Light indicators on the receiver and headset will turn solid white.

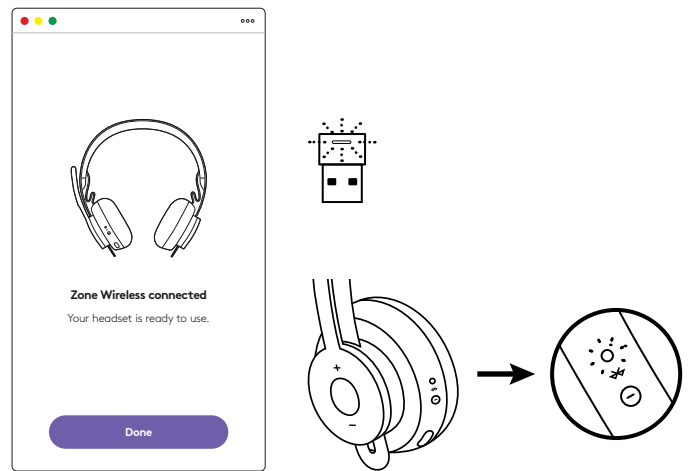

DIMENSIONS

RECEIVER:

Height x Width x Depth: 21.5 mm x 13.6 mm x 6 mm

www.logitech.com/support/zone-wireless-receiver

PRÉSENTATION DU PRODUIT

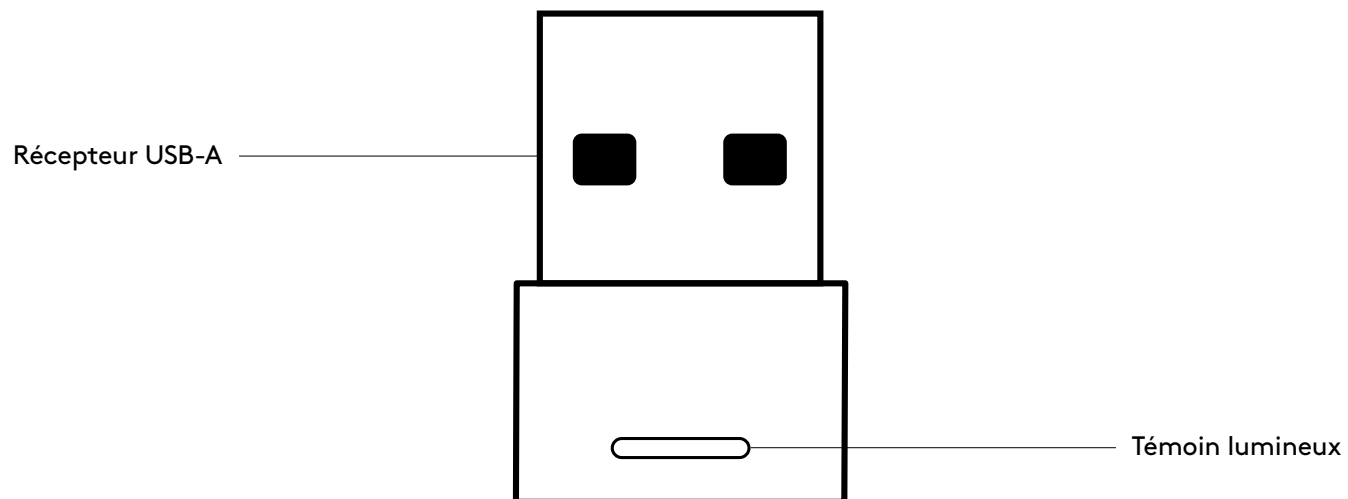

CONTENU DU COFFRET

Récepteur USB-A

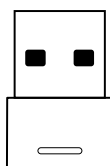

CONNEXION DU RÉCEPTEUR AU CASQUE

- Insérez le récepteur dans le port USB-A de l'ordinateur.
 - Insérez le récepteur dans le port USB-C de l'adaptateur. Insérez ensuite l'adaptateur dans le port USB-C de l'ordinateur.
- Installez et ouvrez Logi Tune Desktop.

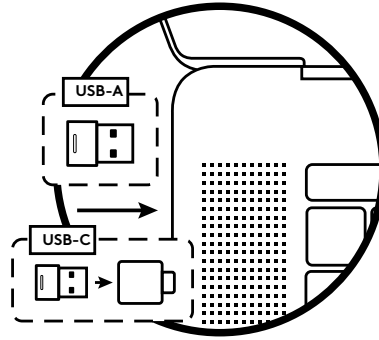

- Téléchargez-le à l'adresse www.logitech.com/logitune
- Logi Tune Desktop confirmera qu'un nouveau

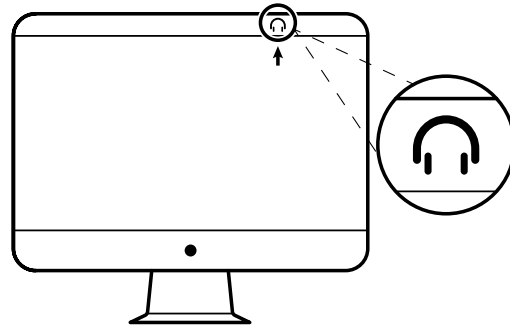

récepteur a été trouvé. Accédez au mode de couplage sur le casque en appuyant sur le bouton d'alimentation pendant 3 secondes. Cliquez sur **Continuer**.

- Si le mode de couplage réussit, les témoins lumineux

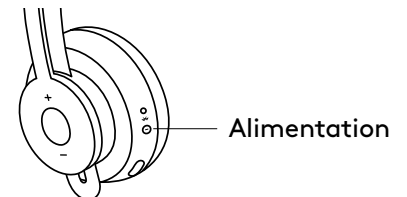
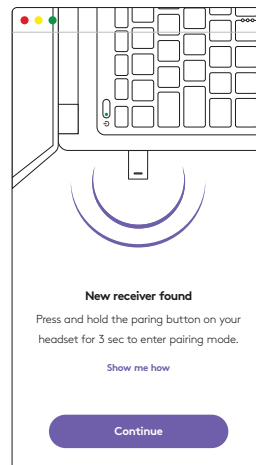

du récepteur et du casque clignotent en blanc.

5. Une fois que vous voyez cet écran, le

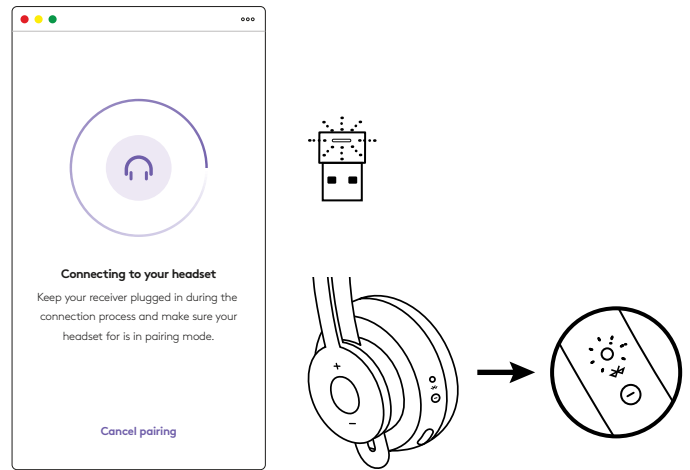

récepteur est maintenant couplé avec le casque. Les témoins lumineux du récepteur et du casque deviennent blancs fixes.

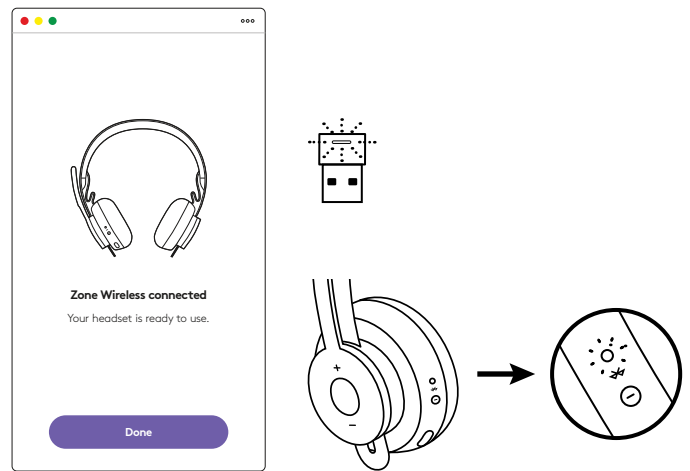

DIMENSIONS

RÉCEPTEUR:

Hauteur x Largeur x Épaisseur: 21,5 mm x 13,6 mm x 6 mm

www.logitech.com/support/zone-wireless-receiver

COMPONENTES DEL PRODUCTO

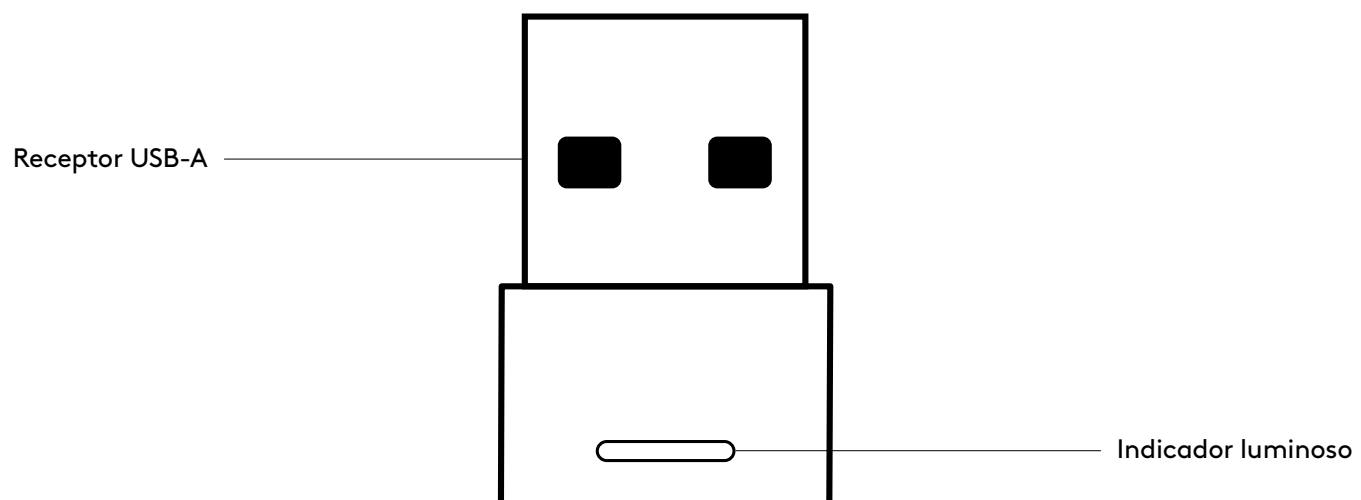

CONTENIDO DE LA CAJA

Receptor USB-A

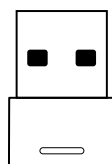

CONECTAR EL RECEPTOR A LOS AUDÍFONOS

- Inserta el receptor en el puerto USB-A de la computadora.
 - Inserta el receptor en el adaptador USB-C. Luego inserta el adaptador en el puerto USB-C de la computadora.

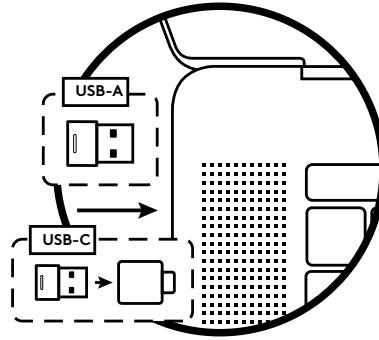

- Instala y abre Logi Tune para escritorio. Descárgalo desde www.logitech.com/logitune

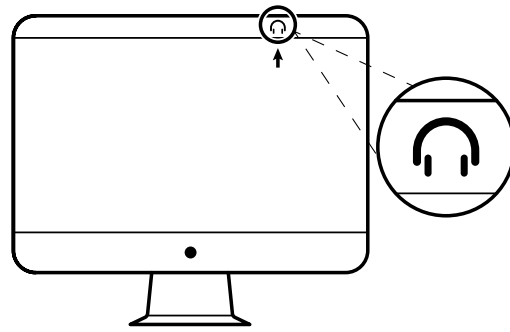

- Logi Tune para escritorio confirmará que se encontró un nuevo receptor. Entra en modo de emparejamiento en los audífonos presionando el botón de encendido por 3 segundos. Haz clic en **Continuar**.

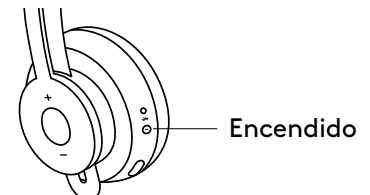
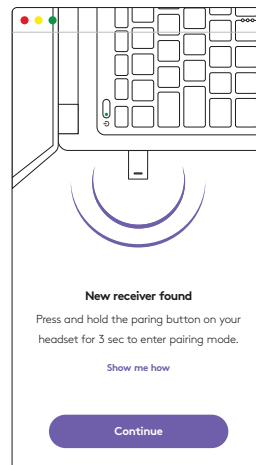

4. Si el modo de emparejamiento es correcto, los indicadores luminosos del receptor y de los audífonos emitirán destellos blancos.

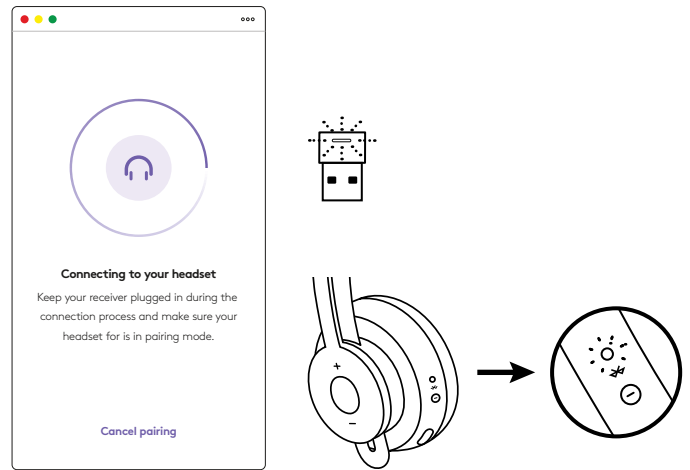

5. Cuando veas esta pantalla, el receptor estará emparejado con los audífonos. Los indicadores luminosos del receptor y de los audífonos se iluminarán con luz blanca permanente.

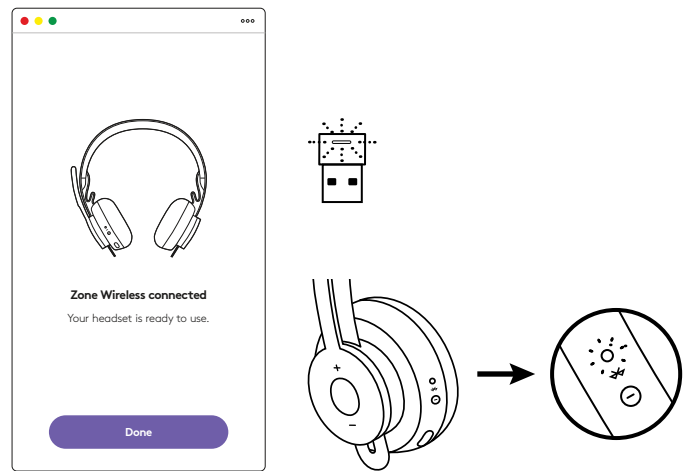

DIMENSIONES

RECEPTOR:

Altura x Anchura x Profundidad: 21,5 mm x 13,6 mm x 6 mm

www.logitech.com/support/zone-wireless-receiver

CONHECER O PRODUTO

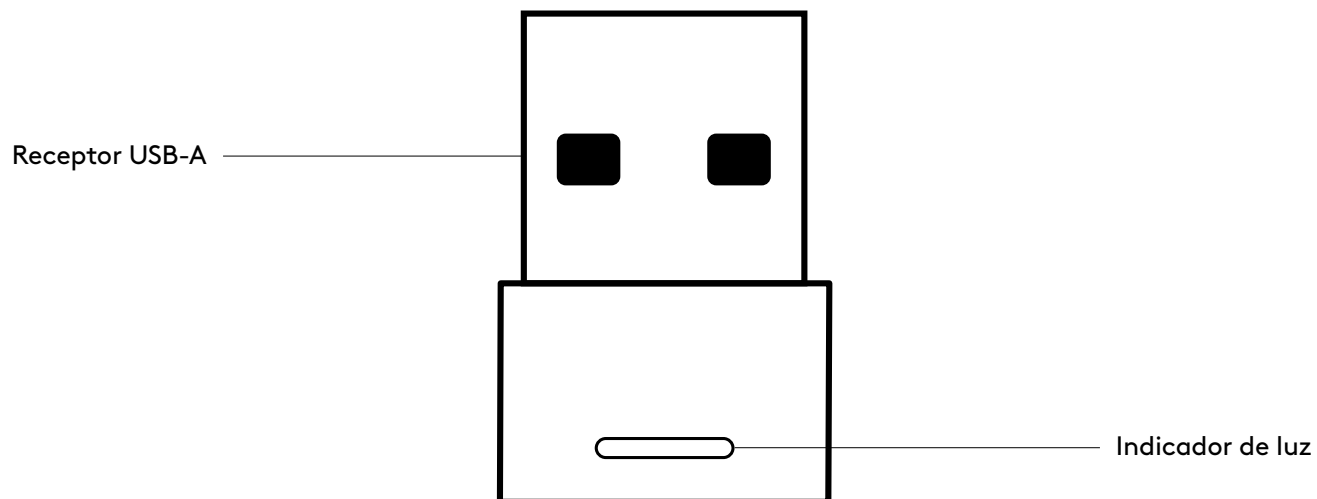

ITENS INCLUÍDOS NA EMBALAGEM

Receptor USB-A

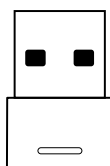

CONEXÃO DO RECEPTOR AO HEADSET

- a.** Insira o receptor na porta USB-A do computador.

b. Insira o receptor no adaptador USB-C. Em seguida, insira o adaptador na porta USB-C do computador.

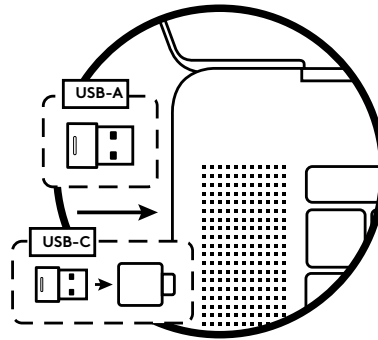

- Instale e abra o Logi Tune Desktop. Faça o download em www.logitech.com/logitune

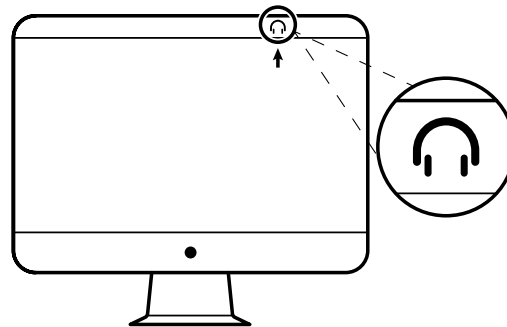

- O Logi Tune Desktop confirmará que um novo receptor foi encontrado. Entre no modo de pareamento no headset pressionando o botão liga/desliga por 3 segundos. Clique em **Continuar**.

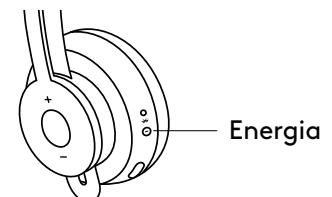
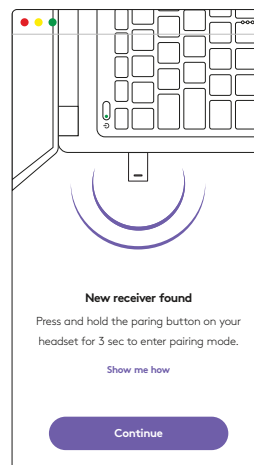

4. Se o modo de pareamento for bem sucedido, os indicadores luminosos no receptor e no headset piscarão em branco.

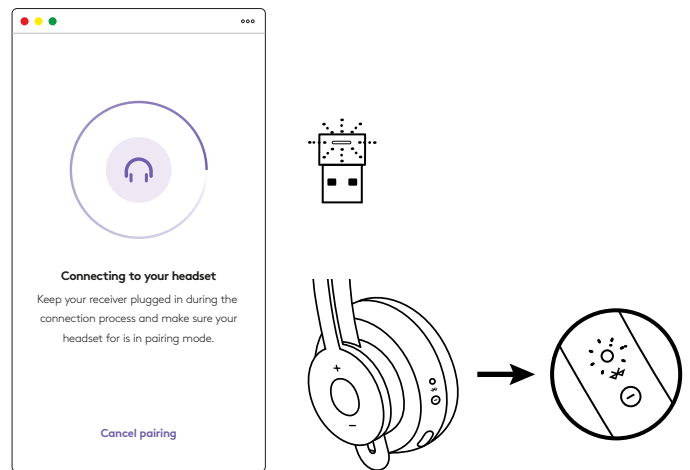

5. Depois de ver esta tela, o receptor estará pareado com o headset. Os indicadores luminosos no receptor e no headset ficarão brancos sólidos.

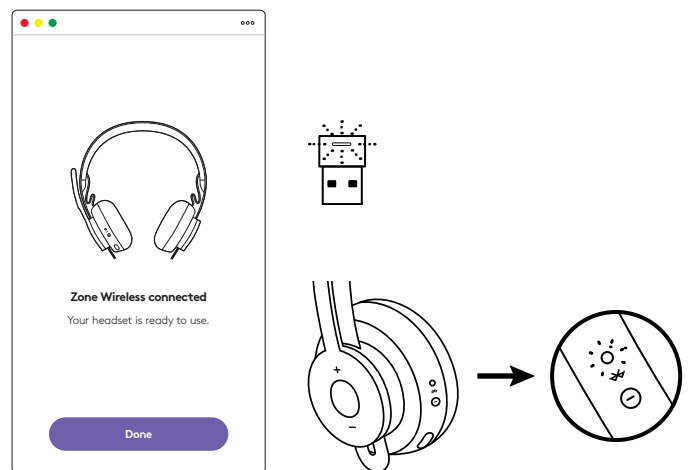

DIMENSÕES

RECEPTOR:

Altura x largura x profundidade: 21,5 mm x 13,6 mm x 6 mm

www.logitech.com/support/zone-wireless-receiver