

G923

Racing Wheel and Pedals For PC

PC 版赛车方向盘和踏板

SETUP GUIDE | 设置指南



logitech 罗技



ENGLISH 3

简体中文 13

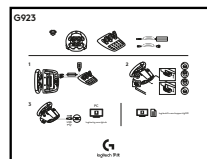
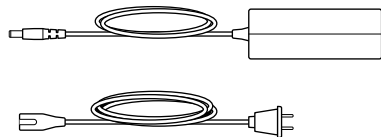
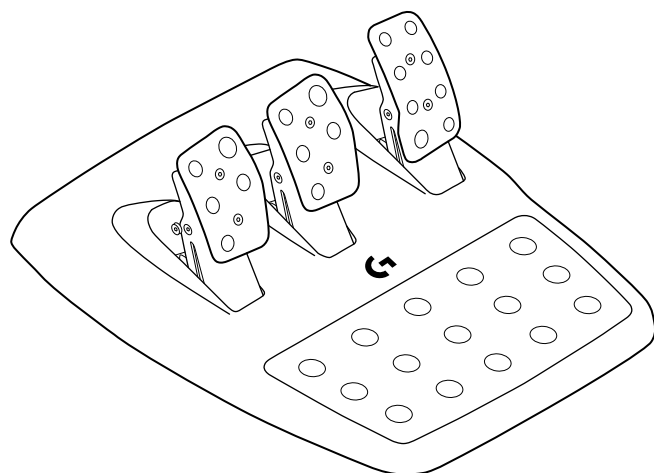
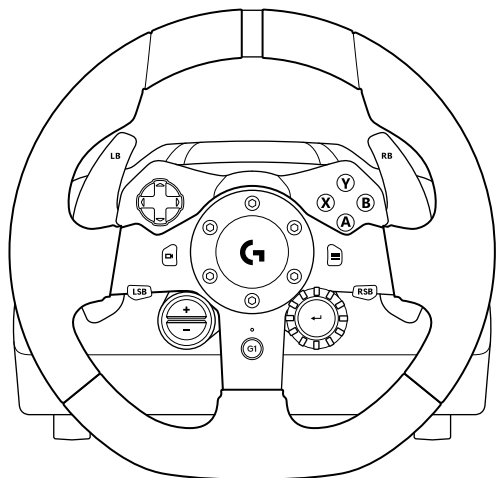

CONNECTIONS AND MOUNT POINTS

- 1 Mounting clamps
- 2 Cable management cleat
- 3 Optional shifter connection (DB-9 male)
- 4 USB cable
- 5 Pedal unit connection (DB-9 female)
- 6 Power connection
- 7 Bolt mounting points (uses M6X1 bolts)

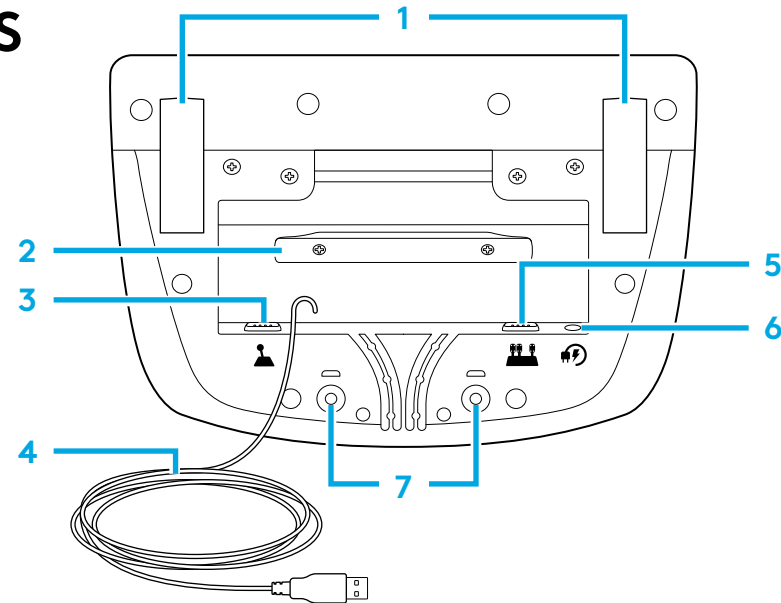

OPTIMAL CABLE ROUTING

USB and pedal cables (1, 2) should be routed through inner channels.

Power and optional shifter cables (3, 4) should be routed through outer channels.

Cables may be wrapped multiple times around cable management cleat to take in slack.

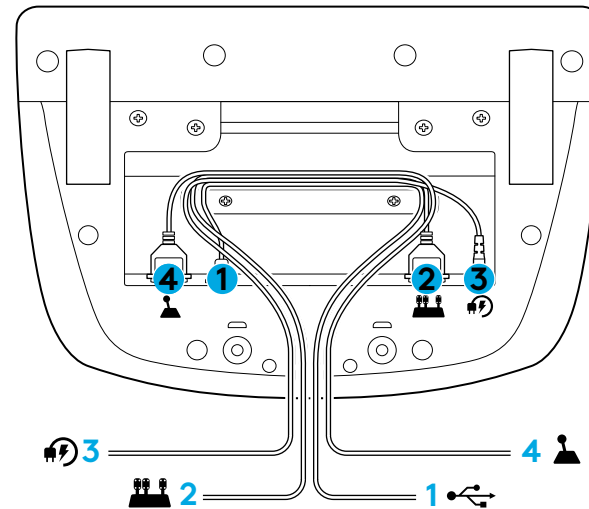

INSTALLATION

Attach power adapter and USB cables as shown.

Every time your racing wheel connects with your system, it will rotate fully to each side and then to the center to calibrate. Your wheel will be ready once this calibration is completed.

For PC to enable the force feedback and RPM LED features on your G923 Wheel and Pedals you must install the Logitech G HUB software. This can be found at logitechG.com/support/g923

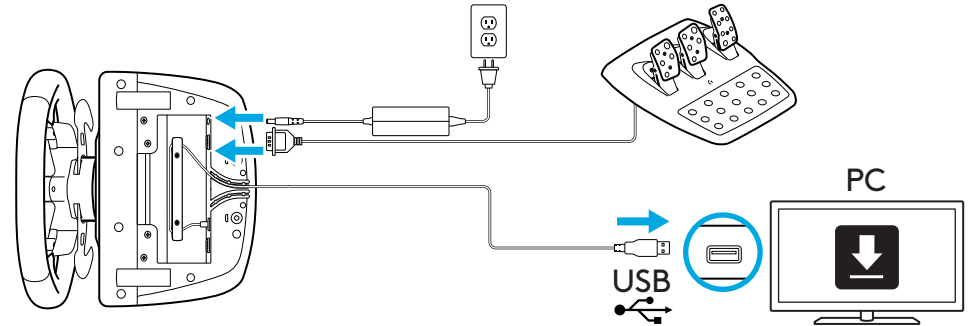

MOUNTING CLAMPS

G923 Racing Wheel is equipped with a built in clamping system for mounting to a table.

Push down and rotate clamp knobs to lock or unlock.

Rotate clamp knobs to tighten or loosen clamps.

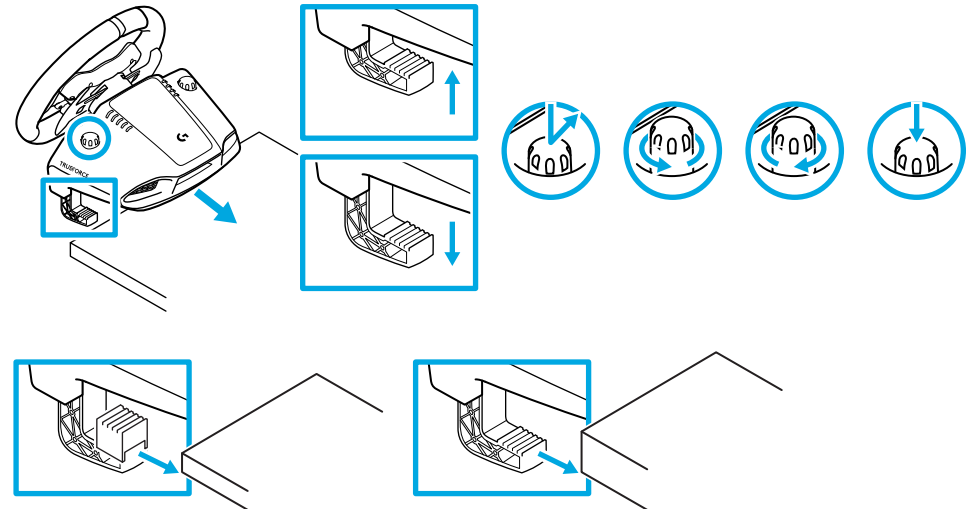

Note: Clamp extenders should be removed for attachment to thicker tables.

BUTTONS

- 1 Left bumper
- 2 Directional pad
- 3 View button
- 4 Left stick button
- 5 +/- Setting Adjustment buttons
- 6 Right bumper
- 7 A, B, X, Y buttons
- 8 Menu button
- 9 Right stick button
- 10 Setting Selection Dial and select button
- 11 G1 button

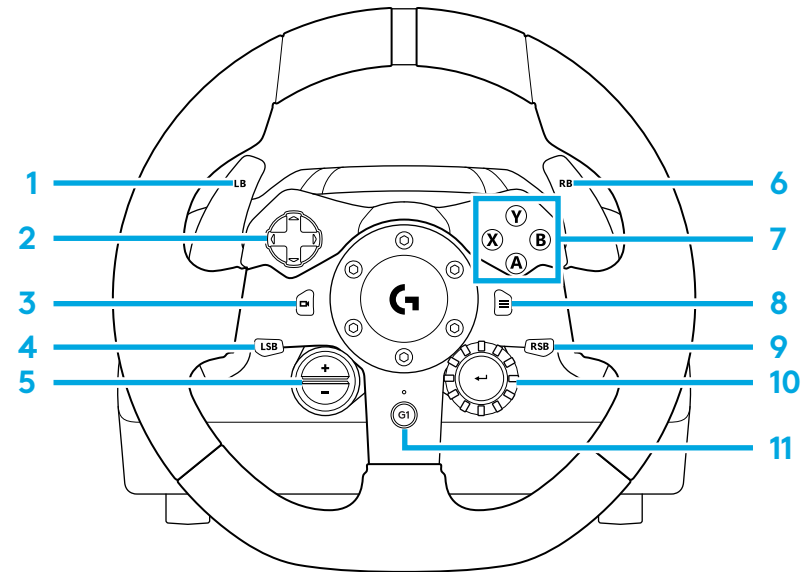

FORCE FEEDBACK

Your Racing Wheel contains dual motors that will provide force feedback with supported games and systems.

In supported titles you will also experience our next generation approach to force feedback: TRUEFORCE.

TRUEFORCE integrates directly with game physics and audio to unlock high-definition, real-time force feedback. Tire grip, suspension, weight, horsepower—even unique engine sound resonance—are immediately and accurately felt through the wheel.

Supported titles may implement TRUEFORCE high-definition force feedback. For a list of supported titles visit logitechG.com/support/g923

Note: Your Racing Wheel has an overheat protection circuit safeguard to protect it under high-temperature operating conditions. In rare instances, force feedback features may shut down during use while controls continue to operate.

If this occurs, allow the wheel to cool down and power it down by unplugging it. If this occurs frequently, contact product support.

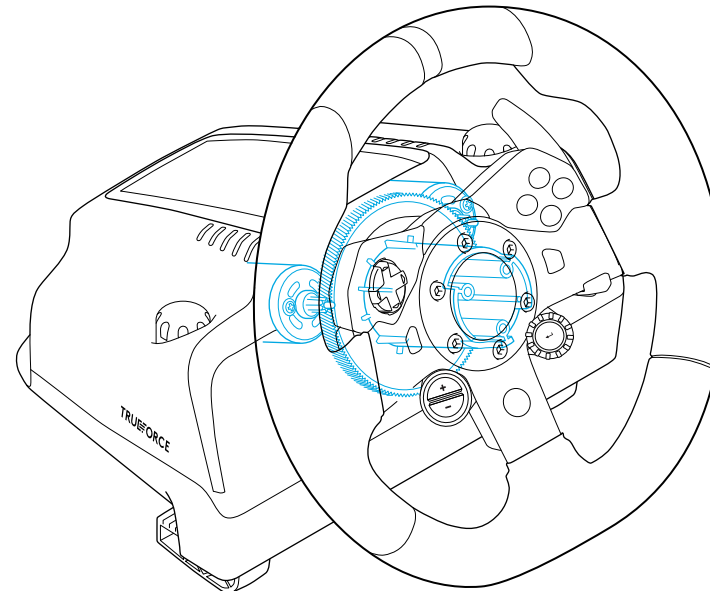
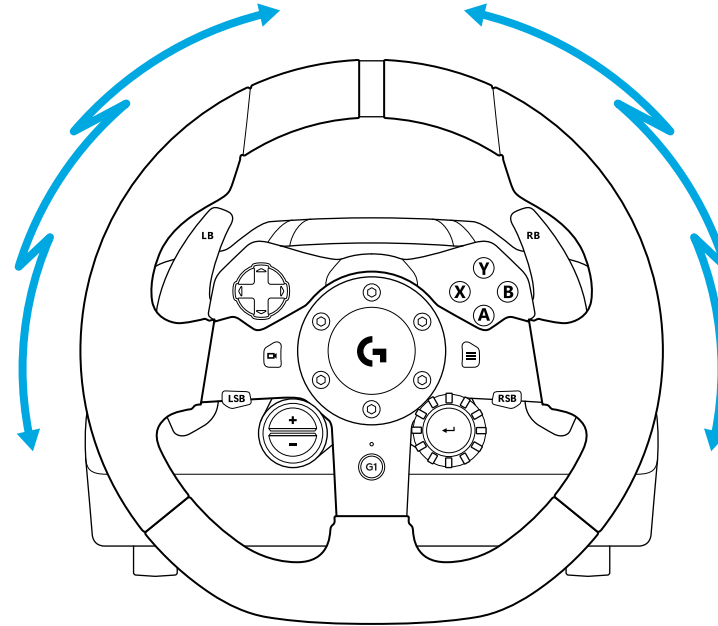

FEATURES

- 1 Clutch pedal
- 2 Brake pedal
- 3 Throttle pedal
- 4 Textured heel rest
- 5 Bolt mounting points (uses M6X1 bolts)
- 6 Patented carpet grip system
- 7 Carpet grip release clip
Push towards rear of pedal unit to release
- 8 Change pedal face position
(requires 2.5mm hex key)

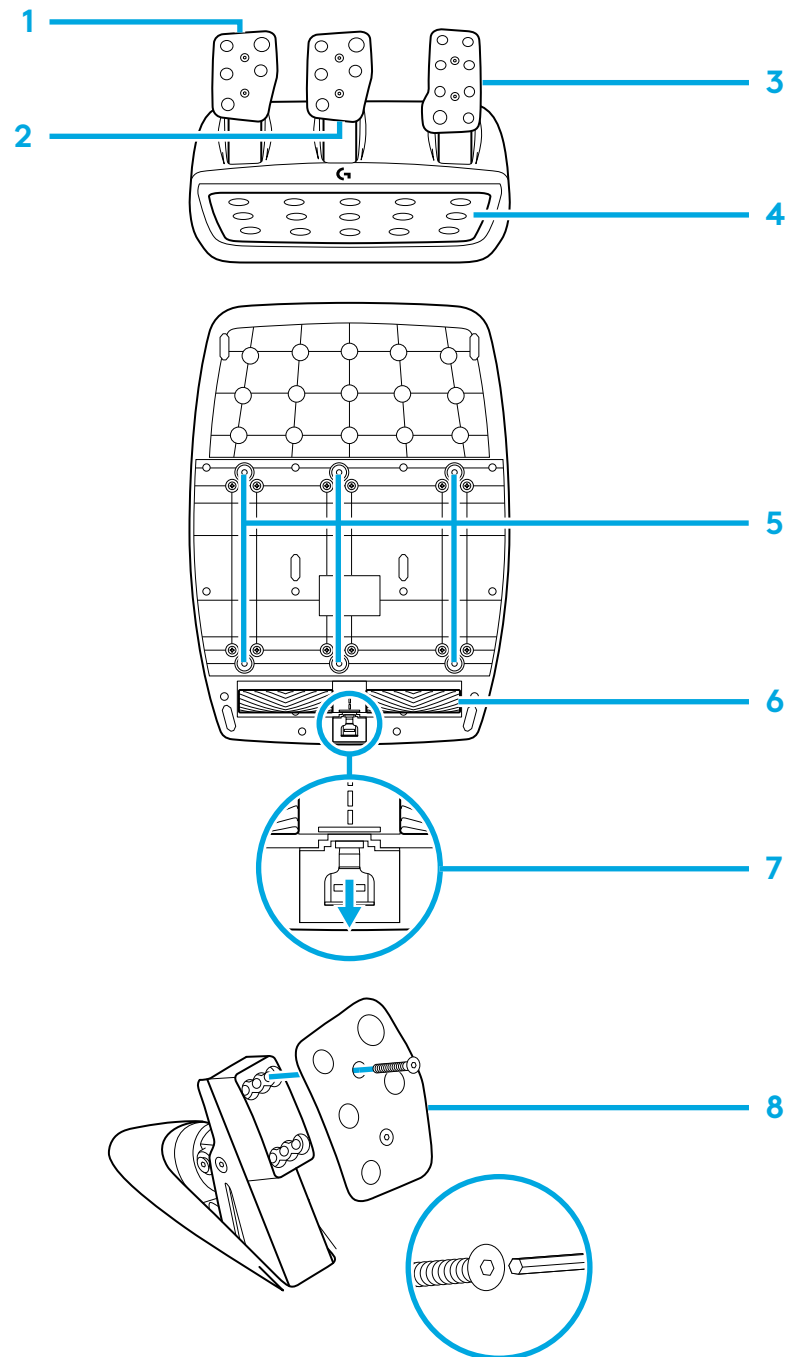

USING THE DUAL CLUTCH IN-GAME

Using a dual clutch system from a grid start in a race enables you to achieve maximum traction without the need to find the bite point of your clutch pedal - this can give you a significant advantage at the start of a race.

To use the dual clutch system in-game:

- 1** At race start, fully depress the clutch pedal and the button assigned to the dual clutch function (see next section for setting instructions).
- 2** Select first gear using the Gear Up Paddle and fully depress the gas pedal.
- 3** As soon as you get the green light for race start, immediately release the Dual Clutch button. The car should start moving as the bite point of the clutch is engaged.
- 4** Smoothly release your foot from the clutch pedal in order to achieve maximum traction. It's worth practicing this last step and modifying the bite point setting several times to find a method that works for you. Once you have it perfected, this feature can help make up several places on the grid.

Note: Support for the dual clutch function is not possible in some games. A list of games that support the dual clutch feature can be found at logitechG.com/support/g923

SETTING UP THE DUAL CLUTCH SYSTEM

- 1 Press and hold the left and right gear paddle and Left stick button and Right stick button together for two seconds to enter dual clutch setting mode. The RPM LEDs will illuminate blue and flash slowly:

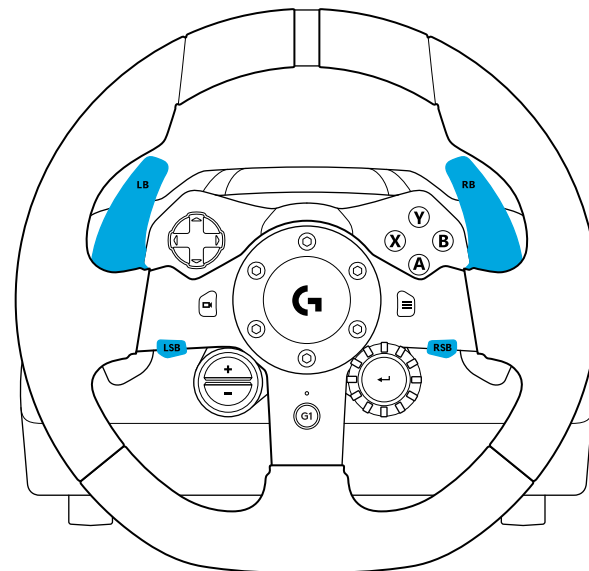

Note: Whilst in the Dual Clutch setting mode the RPM LEDs will not respond to the game/SDK

- 2** Press the button you want to set as the dual clutch button. The only valid buttons for this are the left stick button (LSB) and right stick button (RSB). The RPM LEDs will flash red to show that you're in clutch position setting mode.
- 3** While in your chosen simulation or game with the car still on a track, fully depress the clutch and gas pedals. Engage first gear and keep pressing the minus button down until the car begins to move in-game. You can adjust the precise bite point of the clutch by using the plus and minus buttons until you are happy with the setting.
- 4** At this point you may test the dual clutch without leaving the setting mode. It is recommended you attempt a race start, stop the car and adjust the bite point and then try again until you are satisfied with the performance of the dual clutch.
- 5** Press the Select button in the middle of the dial on the wheel to exit dual clutch setting mode. The RPM LEDs will flash in a sequence from green to blue to show that the setting is saved. The RPM LEDs will then go out and begin responding again to RPM output from supported games.

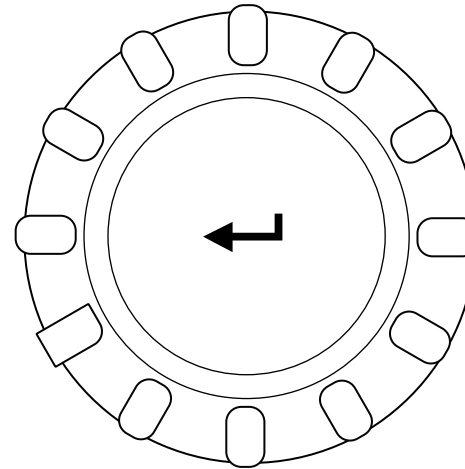
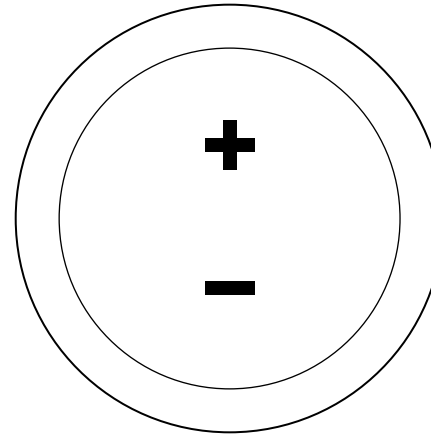

RESETTING DUAL CLUTCH SYSTEM

Press and hold the left gear shift, right gear shift, and X button for two seconds.

The RPM LEDs will all flash four times and then extinguish to indicate that the Dual Clutch system has been reset.

The button assigned to the Dual Clutch system (LSB or RSB) will revert to its normal function.

USING LOGITECH G HUB

Logitech G HUB enables the following features on the G923:

- Button programming with profiles that can be linked to games.
- Adjustment of wheel settings, such as Rotation Angle and TRUEFORCE strength.
- Testing of the various buttons, wheel and pedal functions.

G HUB WHEEL SETTINGS

Sensitivity

Alters the output response of the wheel to be more or less sensitive. Leaving this slider at 50% will provide a linear 1:1 output. Between 51% and 100% will make the wheel increasingly more sensitive around the centre movement of the wheel. Between 0% and 49% will make the wheel decreasingly sensitive around the centre movement of the Wheel.

Operating Range

The G923 is capable of up to 900 degrees of rotation. Reducing this setting will change the point at which the wheel will reach full steering lock. This is especially useful if you're driving a car with a smaller actual steering lock angle, such as a Formula 1 or GT3 car.

Centering Spring (for games without force feedback)

Most games that support force feedback already model the correct return to center function of the G923 based on the virtual car. It is recommended that the Centering Spring option be turned off for these games.

Enabling the Centering Spring option will allow you to override the game features and adjust the strength of the return to center force using the provided slider

Torque

Only available for TRUEFORCE supported games. Torque controls the overall force feedback strength for your G923.

Audio Effects

Only available for TRUEFORCE supported games. Controls the overall strength of the audio-related effects (engine note, rumble strips etc.) when using TrueForce-compatible titles.

If you are using your G923 in older titles that do not support TRUEFORCE then adjustment of the force feedback can be performed from the settings menus of the game title.

G HUB PEDALS SETTINGS

Sensitivity

Alters the output response of the pedals to be more or less sensitive. Leaving this slider at 50% will provide a linear 1:1 output. Between 51% and 100% will make the pedal increasingly more sensitive around the initial movement of the pedal. Between 0% and 49% will make the pedal decreasingly sensitive around the initial movement of the Pedal.

Combined Pedals

If checked, this will set the gas and brake pedals to become two halves of a single axis. This will help the pedals operate correctly in older racing titles that do not support separate axes for pedals.

Note: if left checked then the pedals will not behave correctly in modern racing titles. If you find that just one of your pedals is functioning by accelerating when pressed and braking when released then you should make sure that this option is not checked.

TESTING YOUR WHEEL AND PEDALS

On the wheel and pedals screens in G HUB you can check every button and axis on your G923 in order to ensure everything is functioning correctly. For the wheel you can also see the effect of altering the Operating range.

QUESTIONS?

logitechG.com/support/g923

接口与安装点

- 1 安装夹具
- 2 线缆收纳夹板
- 3 可选变速器接口 (DB-9 公头)
- 4 USB 线缆
- 5 踏板装置接口 (DB-9 雌头)
- 6 电源接口
- 7 螺栓安装点 (使用 M6X1 螺栓)

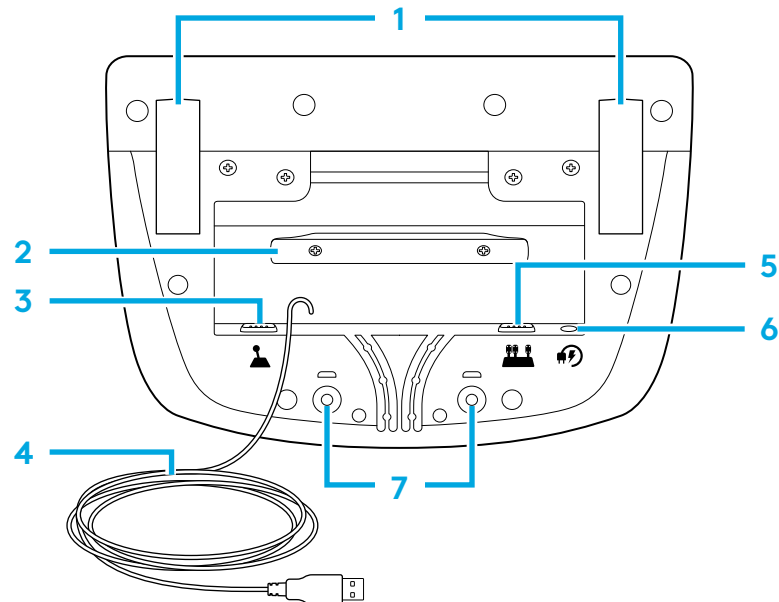

优化布线

USB 和踏板线缆 (1、2) 应走内侧线槽。

电源和可选的变速器线缆 (3、4) 应走外侧线槽。

线缆可能需要缠绕线缆收纳夹板多次才能收紧。

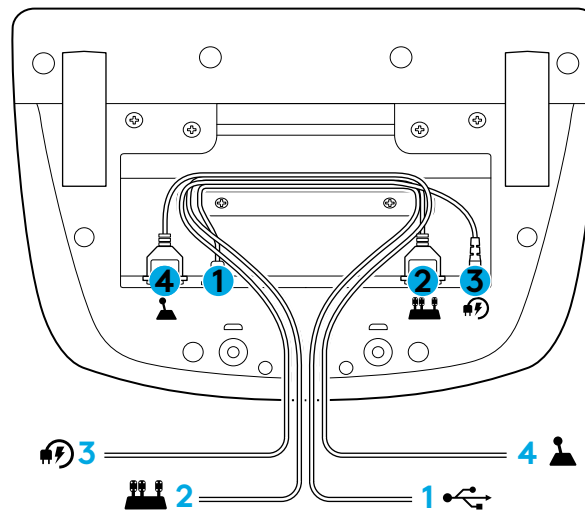

安装

如图所示, 连接电源适配器和 USB 线缆。

每次连接赛车方向盘时, 方向盘会向两侧完全旋转然后回正以进行校准。校准完成后, 方向盘便已准备就绪。

对于 PC, 要启用 G923 方向盘和踏板的力反馈及 RPM LED 功能, 需安装罗技 G HUB 软件。有关信息, 请访问 logitechG.com/support/g923

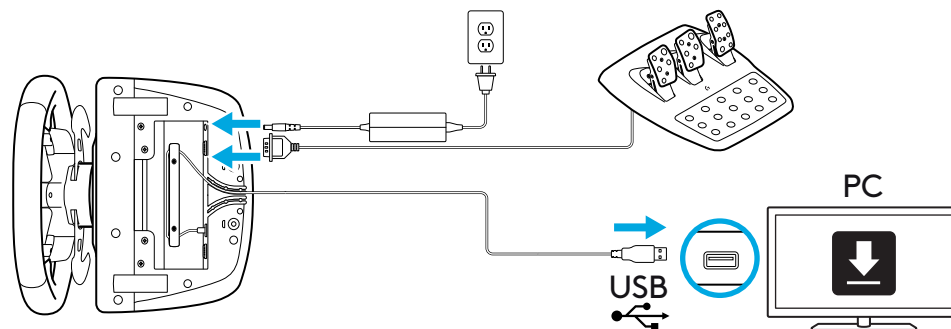

安装夹具

G923 赛车方向盘配备内置夹紧系统, 用于将方向盘安装到桌面上。

按下并旋转夹紧旋钮可进行锁定或解锁。

旋转夹紧旋钮可紧固或松开夹具。

注意: 将方向盘安装至较厚的桌面时, 应取下夹具延长器。

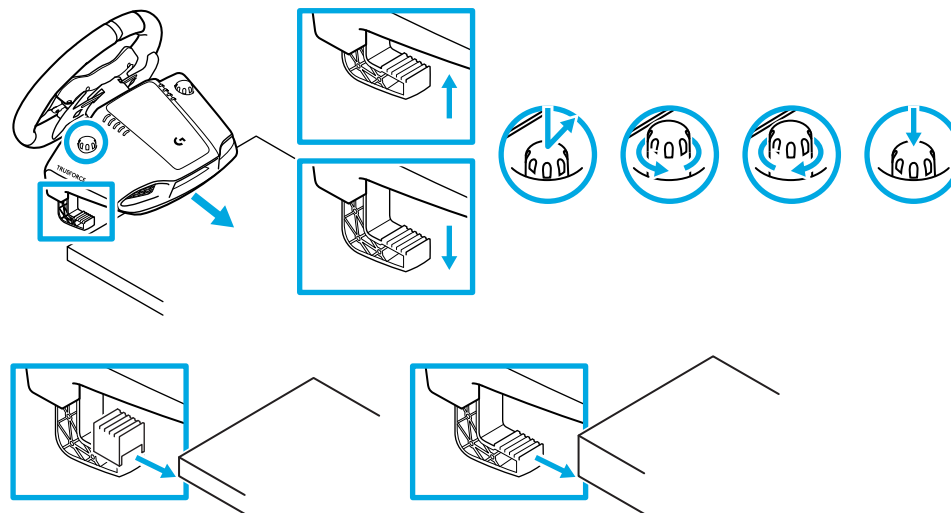

按钮

- 1 左缓冲键
- 2 方向键
- 3 查看按钮
- 4 左操控杆按钮
- 5 +/- 设置调节按钮
- 6 右缓冲键
- 7 A/B/X/Y 按钮
- 8 菜单按钮
- 9 右操控杆按钮
- 10 设置选择转盘和选择按钮
- 11 G1 按钮

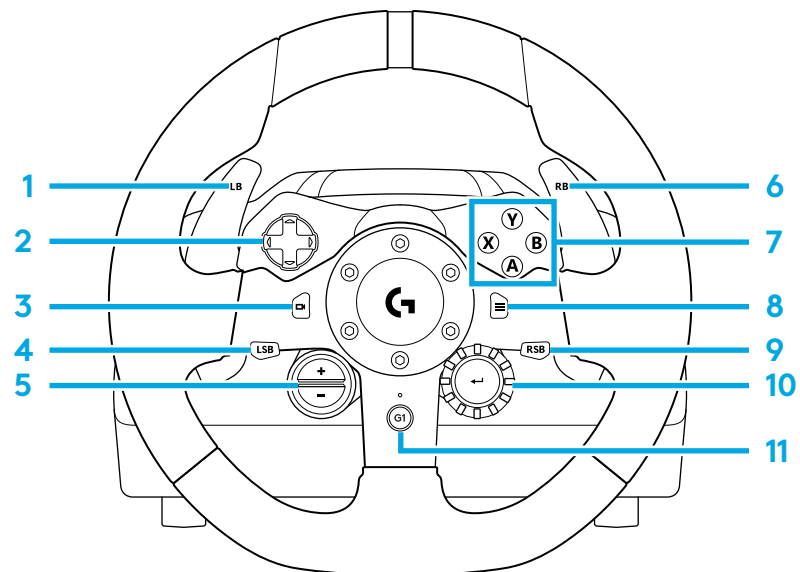

力反馈

赛车方向盘配备双马达, 可在支持的游戏和系统中提供力反馈。

在支持的游戏, 您还将体验我们的全新一代力反馈特性: **TRUEFORCE**。

TRUEFORCE 直接与游戏物理特性和音频相集成, 为您带来精细的实时力反馈。轮胎抓地力、悬挂、重量、马力甚至独特的发动机声音共振均可即时精准地反馈到方向盘上。

支持此特性的游戏作品可以实现 **TRUEFORCE** 精密力反馈。如需获取支持游戏列表, 请访问 logitechG.com/support/g923

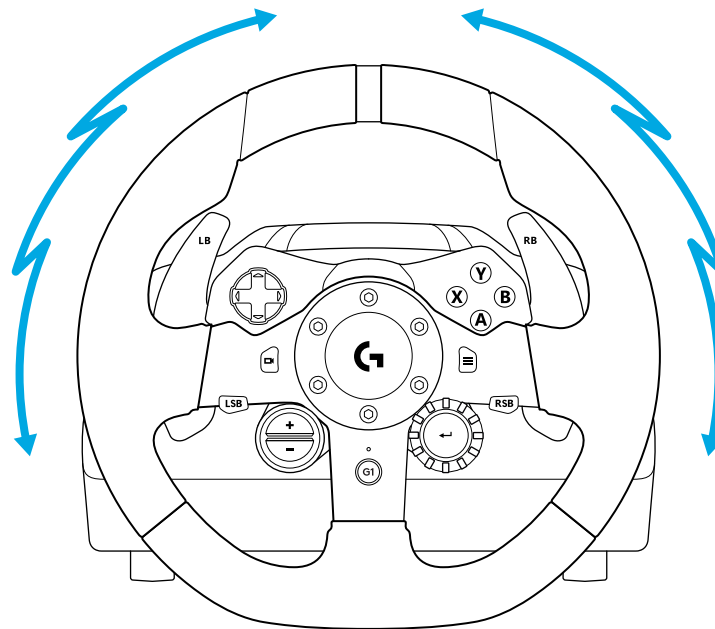

请注意: 赛车方向盘拥有过热保护电路保护装置, 可在高温操作条件下对其进行保护。在极少情况下, 力反馈功能会在方向盘使用过程中关闭, 而控制键会继续工作。

如果发生这种情况, 请断开方向盘的电源, 让方向盘冷却。如果这种情况频繁出现, 请联系产品支持部门。

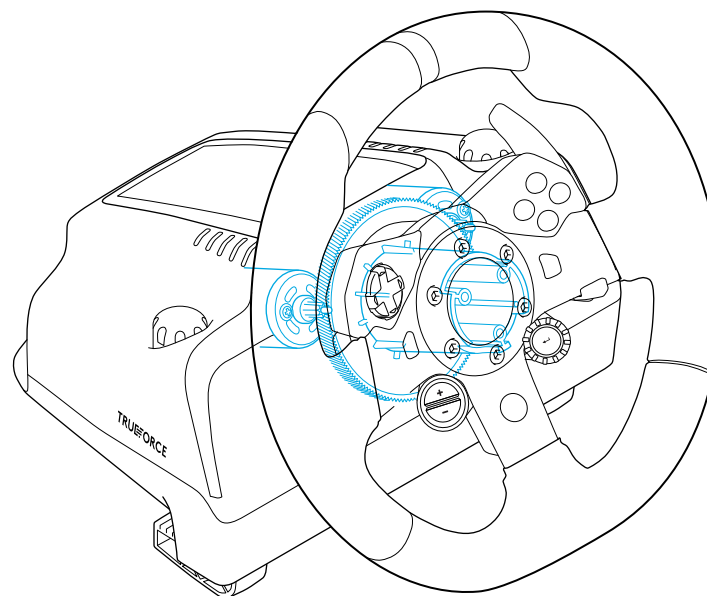

特性

- 1 离合踏板
- 2 刹车踏板
- 3 油门踏板
- 4 纹理脚跟托板
- 5 螺栓安装点 (使用 M6X1 螺栓)
- 6 防滑系统
- 7 防滑系统释放夹
向踏板装置后方推动即可释放
- 8 更改踏板位置
(需使用 2.5 毫米六角扳手)

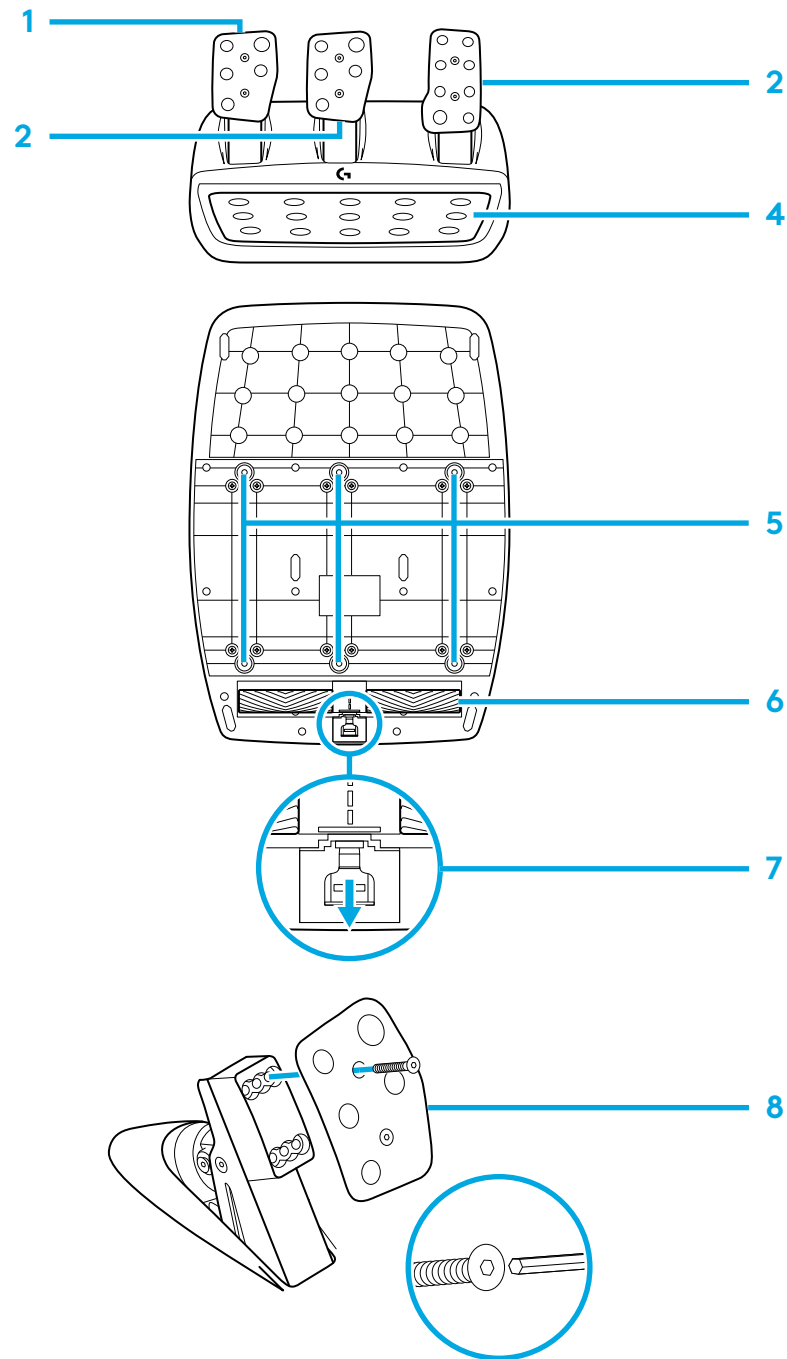

在游戏中使用双离合

在比赛中使用双离合系统启动, 无需寻找离合器踏板的咬合点即可实现最大牵引力, 这可在比赛开始时为您提供显著的优势。

在游戏中使用双离合系统:

- 1** 在比赛开始时, 完全踩下离合器踏板并按下分配给双离合功能的按钮 (相关设置说明请参阅下一节)。
- 2** 使用升档拨片选择一档并完全踩下油门踏板。
- 3** 比赛开始的绿灯亮起时, 立即释放双离合按钮。当离合器的咬合点接合时, 车辆将开始移动。
- 4** 平稳地将脚部从离合器踏板上松开, 以获得最大的牵引力。此步骤值得反复练习, 并尝试修改咬合点设置, 以找到适合您的启动方式。掌握此操作将有助于提升您的比赛成绩。

请注意: 某些游戏不支持双离合功能。支持双离合功能的游戏列表请参阅 logitechG.com/support/g923

设置双离合系统

- 1 同时按住左右换挡拨片以及左操纵杆按钮和右操纵杆按钮两秒钟, 进入双离合设置模式。RPM LED 将亮起蓝色并缓慢闪烁:

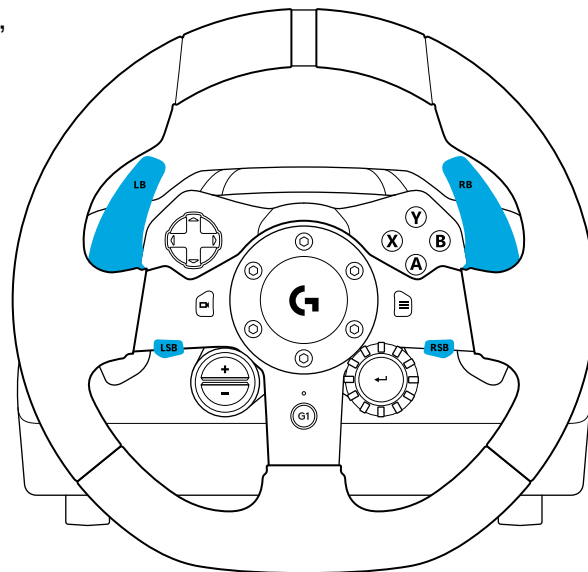

请注意: 在双离合设置模式下, RPM LED 将不响应游戏SDK

2 按下要设置为双离合器按钮的按钮。对此有效的按钮只有左操纵杆按钮 (LSB) 和右操纵杆按钮 (RSB)。RPM LED 将闪烁红色, 表示您处于离合器位置设置模式。

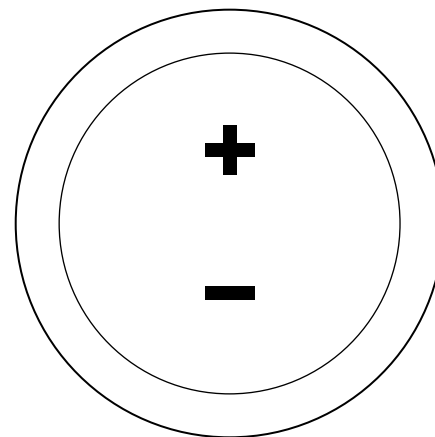

3 在您选择的模拟器或游戏中, 当车辆仍在赛道上时, 完全压下离合器和油门踏板。接合第一档并持续按下减号按钮, 直至车辆开始在游戏中移动。您可以使用加号和减号按钮调整离合器的准确咬合点, 直到您对设置满意为止。

4 此时, 您可以在不离开设置模式的情况下测试双离合功能。建议您尝试在比赛中发车, 停止赛车并调整咬合点, 然后再试一次, 直到您对双离合器的性能感到满意为止。

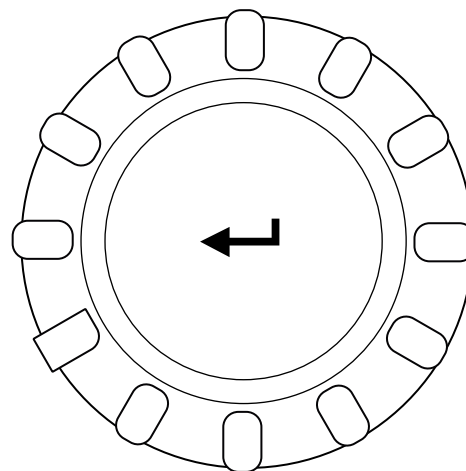

5 按下方向盘转盘中间的选择按钮退出双离合器设置模式。RPM LED 将按照从绿色到蓝色的顺序闪烁, 表示设置已保存。随后 RPM LED 将熄灭并再次开始响应来自支持的游戏的 RPM 输出。

重置双离合器系统

按住左换挡、右换挡和 X 按钮两秒。

RPM LED 将全部闪烁四次然后熄灭, 表示双离合器系统已复位。

分配给双离合器系统 (LSB 或 RSB) 的按钮将恢复其正常功能。

使用罗技 G HUB

罗技 G HUB 可启用 G923 的如下功能:

- 通过可链接到游戏的配置文件进行按钮编程。
- 调节方向盘设置, 如旋转角度和 TRUEFORCE 强度。
- 测试各按钮、方向盘和踏板功能。

G HUB 方向盘设置

灵敏度

调节方向盘的输出响应灵敏度。将此滑块保持在 50% 将提供 1:1 的线性输出。在 51% 和 100% 之间将使方向盘中心运动更加灵敏。在 0% 和 49% 之间将使方向盘中心运动灵敏度降低。

转动范围

G923 最高可旋转 900 度。减小此设置将改变方向盘达到完全转向锁定的点。如果您驾驶的是实际转向锁角较小的车辆, 如 Formula 1 或 GT3 赛车, 此项设置尤其有帮助。

中置弹簧 (适用于无力回馈的游戏)

大多数支持力反馈的游戏已经基于虚拟车辆模拟了 G923 的方向盘回正功能。建议关闭这些游戏中的“中置弹簧”选项。

启用“中置弹簧”选项将允许您覆盖游戏功能并使用提供的滑块调整方向盘回正强度

扭矩

仅适用于支持 TRUEFORCE 的游戏。扭矩控制 G923 的整体力反馈强度。

音频效果

仅适用于支持 TRUEFORCE 的游戏。游玩兼容 TrueForce 的游戏时, 控制音频相关效果 (引擎声、减速带等) 的整体强度。

如果在不支持 TRUEFORCE 的较旧作品中使用 G923, 则可以在游戏的设置菜单中调整力反馈。

G HUB 踏板设置

灵敏度

调节踏板的输出响应灵敏度。将此滑块保持在 50% 将提供 1:1 的线性输出。在 51% 和 100% 之间将使踏板初始运动更加灵敏。在 0% 和 49% 之间将使踏板初始运动灵敏度降低。

组合踏板

如果选中, 则会将油门和制动踏板设置各占半轴。这将有助于在不支持独立踏板轴的较旧赛车作品中正确操作踏板。

注意: 如果保持选中状态, 则踏板在新款赛车作品中将无法正常运行。如果您发现只有一个踏板在踩下时加速并且在释放时制动, 则应确保未选中此选项。

测试方向盘和踏板

在 G HUB 的方向盘和踏板窗口中, 您可以检查 G923 上的每个按钮和轴, 以确保一切正常运行。对于方向盘, 您还可以看到改变操作范围的效果。

有疑问?

logitechG.com/support/g923



© 2024 Logitech. Logitech, Logitech G and the Logitech and Logitech G logos are trademarks or registered trademarks of Logitech Europe S.A. and/or its affiliates in the U.S. and other countries. All other trademarks are the property of their respective owners. Logitech assumes no responsibility for any errors that may appear in this manual. Information contained herein is subject to change without notice.

版权所有 © 2024 Logitech。罗技、罗技 G、Logitech、Logitech G 及其各自标志为罗技欧洲公司和/或其在美国及其他国家/地区附属公司的商标，并或已注册。所有其他商标均是其各自所有者的财产。罗技对于本手册中可能出现的任何错误不承担任何责任。本手册中包含的信息如有更改，恕不事先通知。本说明书内所使用的数据如无特别说明均来自罗技有限公司和/或其关联公司和/或其指定的供应商。

WEB-621-002621 002